

BEAR RIVER COMMISSION

LIBRARY COPY

USGS-3-22

Report # 22

W. N. Jibson

WALLACE N. JIBSON

EXISTING IRRIGATION RESERVOIRS

in

BEAR RIVER BASIN

above

BEAR LAKE

Preliminary Report, not for release to the public, and subject to revision. This report is for restricted use by the Bear River Compact Commission and its Committees and is not to be published, reproduced or circulated, except by the approval of the Director of the U. S. Geological Survey.

Prepared By

W. N. Jibson, Hydraulic Engineer
U. S. Geological Survey

November 28, 1951

Additional Reservoir Permits
Wyoming
in 1953-54 Biennial Rep (Suppl. A)
Crompton (pleasant valley)
Garrett Spring

-1-

EXISTING RESERVOIRS ABOVE BEAR LAKE

At the Bear River Compact Drafting Committee meeting held in Salt Lake City on August 1, 1951, it was recommended that a listing of all existing reservoirs above Bear Lake be included in Article V of the Proposed Compact. A listing of all existing reservoirs as extracted from published adjudications was prepared by the Logan Project Office and presented to the Bear River Compact Engineering Committee at Salt Lake City on August 23, 1951. It was recommended by that Committee that the State Engineers examine their records to insure that all permits, filings, adjudications and decrees, were included and that the Logan Project Office make an examination in the field to check the recorded rights. Since time was limited and because accurate field surveys would be both time consuming and costly, the Committee suggested that the field examinations be limited to making only approximate checks on capacities.

This report has been prepared as a matter of record of the extent of the field examinations made by the Logan Project Office, U. S. Geological Survey.

Using as a guide the adjudication lists supplied by the states, a field examination was made of all listed irrigation and many stock reservoirs. Where feasible, stock reservoirs were examined in order to definitely exclude them from the category of irrigation or dual purpose reservoirs. In addition to the listed reservoirs, quite a number, apparently with incomplete or no filing, were found by checking with other Agencies and with local ranchers.

This summary includes, with a few exceptions, only those reservoirs having outlet works which would permit emptying of contents and use for irrigation. The exceptions are those reservoirs found to be solely for stock, which were adjudicated for stock and irrigation use or without a definite use shown. The majority of stock reservoirs examined were found to be less than 20 acre-feet in capacity.

-6-

Where maps could be found, usually in connection with filings, the reservoirs were briefly examined for evidence of modification. If they appeared as mapped, the surveyed capacity was used. Instances in which capacity tables based on possible future enlargements were available, e.g., Neponset and Crompton reservoirs, accurate elevations were established from bench marks or outlet works to the present spillway crests and the capacity interpolated. This determination for these larger reservoirs is quite accurate.

In most other cases an approximate planetable survey was made by the Logan Office, plotted and computed as shown in the accompanying sketches. Accuracy of these surveys will vary according to the amount of live storage water impounded at the time of checking. A few were filled to capacity, necessitating some soundings by boat to get approximate bottom contours. These planetable surveys are not comparable in accuracy to the usual capacity surveys required for permit or adjudication. However, in the aggregate they should balance out fairly close.

Wyoming

IRRIGATION RESERVOIRS

NAME	SOURCE <i>WYOMING</i>	LOCATION	DATE OF PRIORITY	CAPACITY IN ACRE-FEET	
				ADJUD.	LOGAN OFFICE SURVEY
Noblitt No. 1	Erwin Cr. by Diversion.	S $\frac{1}{2}$ sec 20 T25N R119W	9/21/07	31.2 ✓	(34.3) measured.
Noblitt No. 2	Potato Creek	E $\frac{1}{2}$ sec 30 T25N R119W	9/21/07	18.0	(8.3) measured.
Noblitt No. 3	Potato Creek	NE $\frac{1}{4}$ sec 30 T25N R119W	9/25/09	24.5	(4.4) measured.
Noblitt No. 4	Erwin (Diverted to No. 1 Res.)	N $\frac{1}{2}$ sec 19 T25N R119W	9/21/07	10.5	(6) estimated.
Noblitt	Poison Creek	E $\frac{1}{2}$ sec 2 T24N R120W	8/2/09	21.5	(10.9) measured.
Noblitt	" "	Sec 1 T24N R120W	8/2/09	9.4	(7.4) measured.
Noblitt	" "	W $\frac{1}{2}$ sec 2 T24N R120W	8/2/09	11.2	(9.3) measured.
Hawkins	Hawkins Cr. - Smiths Fork	Sec 22 T 26N R118W	6/29/10	14.1	Abandoned.
Frederick No. 1	Trail Cr. - Sublette Cr.	Sec 1 T23N R119W	6/3/10	1.32	Washed out, abandoned.
Stoffers	" "	Sec 1 T23N R119W	8/16/10	3.74	Washed out, abandoned.
Holland	Leeds Creek	Sec 33 T23N R119W	10/21/11	65.32	(29.6) measured.
Ellen	Antelope Creek	SW $\frac{1}{4}$ sec 4 T22N R119W	6/1/14	12.8	(2) estimated.
Frame	Spring - Rock Cr. - Twin Cr.	Sec 9 T23N R118W	9/27/27	1.27	Stock reservoir.
Rich	Hartley Creek - Twin Cr.	Sec 21 T22N R117W	10/3/14	72.5	Washed out, abandoned years ago.
Gus	Dipper Cr. - Hartley Cr. - Twin Cr.	Sec 13 T22N R118W	8/4/09	20	Apparently nonexistent.
Anna	Linden-W.Fk. " "	Sec 24 T22N R118W	8/4/09	12	Apparently nonexistent.
E. W. Smith	Spring Cr. Bridger Cr.	Sec 34 T20N R120W	10/20/14	20.7	Apparently stock if existent.
Quealy	Birch Creek	Sec 25 T25N R119W	10/12/14	97.1 ✓	(97.4) measured.
Angelo	South Fork Twin Cr.	Sec 24 ⁶ T21N ²⁰ R118W ¹¹⁷	?	?	(20) estimated.
Angelo	Buyer Cr. - Twin Cr.	Sec 12 ³⁴ T21N ¹¹⁷ R118W	9/4/47	29.64	(20.9) measured.
Chas. Smith	South Fork Twin Cr.	NE $\frac{1}{4}$ sec 22 T21N R117W	<i>Being Filed</i>	80.	(80) (Capacity from owner) & SCS

Wyoming (cont'd.)

IRRIGATION RESERVOIRS

NAME	SOURCE	LOCATION	DATE OF PRIORITY	CAPACITY IN ACRE-FEET	
				ADJUD.	LOGAN OFFICE SURVEY
Richey (C. Smith)	South Fork Twin Creek	Sec 5 & 6 T20N R117W	7/11/16	135.95	135.95 from filing.
Chas. Smith	South Fork Twin Creek	Sec 27 T21N R117W	10/26/16	84.55	113 filing plus enlargement.
Alfred Thoman	Gooseberry Draw - Twin Creek	NNE sec 3 T21N R119W	9/16/43	98.08	98.08 from S.C.S. records, and filing.
E. H. Jackson	Chalk Cr.	NW 1/4 sec 10 T25N R119W			29.8 measured.
Crompton	Pleasant Valley Cr. Bear R.	Sec 9 T15N R120W	1/20/28	90.83	475 from U.S.B.R. Survey
"	" " "	"	11/13/34	157.98	
"	" " "	"	4/25/40	208.68	
Pacific Fruit	Bear River	Sec 21 T15N R120W	1/19/11	118.0	Ice production, no longer used.
Heber	Trib. to Willow Cr.	Sec 36 T13N R119W	8/21/06	270.0*	240 measured.
Blake	Willow Cr. by Diversion.	NWNE 7 T13N R119W	12/15/49	152.70	Filed, to be built this fall.
Rasmussen	Springs - Yellow Cr.	Sec 2 T14N R121W	1/4/17	8.25	Stock reservoir.
Dock (D. Boise)	West Sheep Creek	Sec 35 T22N R118W	7/29/08	11.0	Reported stock use for many years. Not inspected.
Morgan	Unnamed - Rock Cr. - Twin Cr.	Sec 15 T22N R118W	6/28/16	37.15	Reported stock use for many years. Not inspected.
East (A.V. Quinn)	Sulphur Cr. - Yellow Cr.	Sec 6 T14N R120W	9/20/07	25.0	Reported most of dam washed out. Stock use only. Not inspected.
Myers	Null Cr. by div. from Mill Cr.	Sec 13 T13N R120W	3/28/39	556.5	140 est. present cap. Not completed.
Painter	Pleasant Valley Cr.	Sec 31 T16N R119W	12/7/43	167.61	167.61 from filing. Built as specified.
Chesney	Thomas Canyon - Bear River	Sec 11 T15N R121W		128.35	Reported washed out, abandoned for many years. Not inspected.
Maninfior	Spring Cr. - Bear River	Tr 121 T25N R119W	10/31/45	9.76	9.76 from filing. Power and irrigation.
Martin (Noblitt)	Pine Cr. & Sublette Cr.	Sec 6 T24N R118W	11/8/44	1.25	1.25 Not inspected.
* 270.0	Permdt; 388.5 mapped (State Engineer's record).				

Wyoming (Cont'd.)

IRRIGATION RESERVOIRS

NAME	SOURCE	LOCATION	DATE OF PRIORITY	CAPACITY IN ACRE-FEET	
				ADJUD.	LOGAN OFFICE SURVEY
Larson (Noblitt)	Pine Cr. - Smiths Fork	Sec 11 T24N R119W	5/28/43	3.81	3.81 Not inspected.
Hamilton	Hamilton Spring Cr.	Sec 31 T25N R119W	5/28/04	3.75	Evidently stock. Not inspected.
			State Total	2,745.99	1,744.76 Includes only circled amounts

Sulphur Cr. Res. Co.

Sulphur Cr

Sec 27 T14N R119W

2/14/50

4,104.13 *

* Not constructed; Good standing to 12/31/53

EXISTING RIGHTS

* Not included in Totals

1,744.76 Logan Office Survey (1951)
 - 3.1 Noblitt #1 - To Check Adjudication
 - 0.3 Quealy " " "
 - 20.0 Angelo (So. Fk) Unadjudicated
 - 80.0 Chas Smith (So. Fk) "
 - 17.51 Crompton - To Check Adjudic.
 + 152.70 Blake - Built 1951-54
 + 416.5 Myers - Enlarged 1951-54
 - 29.8 E.H. Jackson - Unadjudicated

EXISTING RESERVOIRS
(Black check mark ✓)

2293.35 ac-ft

2,163.25 Rounded to 2,150 in Bear R. Compact

UTAH

IRRIGATION RESERVOIRS

NAME	SOURCE	LOCATION	DATE OF PRIORITY	CAPACITY IN ACRE-FEET	
				ADJUD.	LOGAN OFFICE SURVEY
North	Woodruff Cr. by Diversion	NW ¹ sec 9 T9N R7E	1899	55.0 ✓	145 * from Utah Water & Power Bd
Johnson	Six Mile Cr.	Sec 25 T13N R7E	1881 ?	717.0	506 ✓ Approx. (Rebuilt)
Little Creek	Little or Randolph Cr.	Sec 25 T11N R6E	1920	614.0	614 ✓ from filing.
Birch Cr. (LONE PINE #2)	Birch Cr. - Woodruff Cr.	Sec 19 T9N R6E	1884 -	2256.0	2256 ✓ Filing (Under const.)
Lone Pine #1	Birch Cr. - Woodruff Cr.	Sec 19 or 20 T9N R6E		188.0	169 ✓ Approx.
Woodruff Town	Woodruff Creek	Sec 17 T9N R7E	1899	126.0	66 (660) * * Right to fill 10 times yearly.
Neponset	Bear River	Sec 34 & 35 T8N R8E	8/28/05	6000.0	6900 ✓ Present spillway from U.S.B.R.
Spring Hollow	Saleratus Cr.	Sec 25 T7N R6E	1873	Est. 212	Abandoned dike located.
Beaver	Saleratus Cr.	Sec 2 T6N R6E -	1873	Est. 800	303 ✓ measured (lower res.)
Deseret L. Co.	Saleratus Cr.	Sec 2 T6N R6E -		0	65.5 ✓ measured.
Deseret L. Co.	Saleratus Cr.	Sec 11 T6N R6E -		0	37.4 ✓ measured.
Deseret L. Co.	Saleratus Cr. (East Fk.)	Sec 12 T6N R6E -		0	63.0 ✓ measured.
Crane	Duck Cr. - Wasatch - Yellow	Sec 10 & 11 T6N R7E	1900	Est. 668	732 ✓ measured.
Hopkins, Rees	Dry Wash	Sec 6 T9N R8E	1901	1990 15.4	75 ✓ estimated.
				11,448.0	12,525.9
<p>12,525.9 Unadjusted Total</p> <p>* * - 594.0 Woodruff Town R. adj. to one filling</p> <p>* - 90.0 North R. to Adjudication</p> <p>11,841.90 af</p> <p>Recognized in Compact: 11,850 af. (Rounded)</p>				<p>includes approx 650 ac. ft. in res. without adjudications</p> <p>Depending on classif. of 'North' { 11,931.90 Lt. Compact. 11,841.90 ←</p>	
<p>2160</p> <p>324</p> <p>11932</p> <hr/> <p>14416</p> <p>324</p> <hr/> <p>14,092</p>					

IDAHO

IRRIGATION RESERVOIRS

NAME	SOURCE	LOCATION	DATE OF PRIORITY	CAPACITY OF ACRE-FEET	
				ADJUD.	LOGAN OFFICE SURVEY
Sheep Creek	Sheep Creek	Sec 36 T13S R45E		121.33	215 Approx.; dam raised.
Covey	Wood Canyon	SW $\frac{1}{4}$ sec 8 T13S R46E			5.8 measured.
Covey	Wood Canyon	SE $\frac{1}{4}$ sec 7 T13S R46E			66.3 measured.
Covey	Wood Canyon	SE $\frac{1}{4}$ sec 7 T13S R46E			37.0 measured.
State Total				121.33	324.1 - 0/K
Three-State Totals				14,315.32	14,594.76 <i>includes right of Woodruff</i>

Approx ²³¹⁷ ~~1708~~ ac.ft ^{existing.} Capacity of later dated rights than 1911 storage rights. $\frac{660}{594}$

town (66 ac ft) to fill ten times yearly. If 660 reduced to 66.

14,594.76
 - 660.
 + 66.

 14,000.76

RESERVOIRS

Wyoming

Potato Creek & Erwin Cr.

owner: J.D. Noblitt
Cokeville, Wyo

Noblitt #3

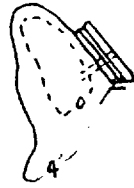

1" = 500'

Tr 53 T25N R119W

↳ sec 29 830



Elev Outlet = 0

Elev. W.S. = -1.5

Elev. Spill = 4

Elev	Acres	Ave.	Ac.Ft.	Total
0	.6			
4	1.6	1.1	4.4	4.4 ac.ft.

Noblitt #2



Tr 56 T25N R119W

↳ sec 30 (0.2 mi above #3)

Elev. Outlet = 0'

Elev. W.S. = 9.

Elev. Spill = 9.

W.S.

1" = 500'

Elev.	Acres	Ave.	Ac.Ft.	Total
0	0.1			
4	0.9	0.5	2.0	
9	1.7	1.3	6.3	8.3 ac.ft.

Noblitt #1

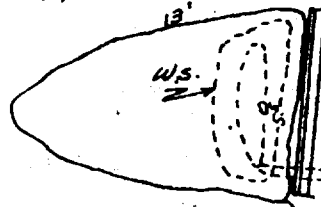

8 1/2 Sec 20

Tr 59 T25N R119W

Elev. Outlet = 0'

Elev. W.S. = 5.5

Elev. Spillway = 13'

Elev Top dam = 17'

1" = 500'

This reservoir in Wash between Potato and Erwin creeks and is filled by diversion pipe from Noblitt #4 on Erwin Cr.

Elev.	Acres	Ave.	Ac.Ft.	Total
0	0.5			
5.5	1.5	1.00	5.5	
13.	6.2	3.85	28.8	34.3 acft

Remarks:

Noblitt #4, Erwin Cr, is used only as a diversion reservoir to fill Noblitt #1. Field inspection indicates it's listed capacity of 10.5 ac.ft. is higher than actual capacity. Estimated 6 ac.ft. Potato Cr. reservoirs (Noblitt #2 & #3) are considerably smaller than adjudicated.

Oct 1951

W.N.J. & B.S.P.

RESERVOIRS Wyoming

Poison Creek

owner: J. D. Noblitt
Cokeville Wyo.

3 reservoirs



Elev. Outlet = 0
Elev. W.S. = 2'
Elev. Spill = 10'
Elev. Top dam = 13' approx.

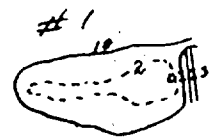

Scale 1" = 500'
W2 Sec 2 T24N R120W

Elev.	Acres	Ave	Ac.Ft.	Total
0	0	.25	.50	
2'	.5	1.10	8.8	9.3 ac.ft.
10'	1.7			

Elev. Outlet = 0
Elev. W.S. = 6'
Elev. Spillway = 12.5'
Elev. top dam = 16'

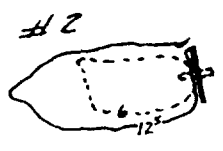

Scale 1" = 500'
E2 Sec 2 T24N R120 W
half mile below #1

Elev.	Acres	Ave	Ac.Ft.	Total
0	0	.4	2.4	
6'	.8	1.3	8.5	10.9 ac.ft.
12.5'	1.8			

Elev. outlet = 0
Elev. W.S. = 9'
Elev. Spillway = 11'
Elev. Top dam = 13'



Scale 1" = 500'
Sec 1 T24N R120W
Half mile below #2

Elev.	Acres	Ave.	Ac.Ft.	Total
0	0	.18	0.9	
5'	.35	1.08	6.5	7.4 ac.ft.
11'	1.8			

Remarks:

1944 listing includes one reservoir on Poison Creek
with Capacity of 21.5 ac.ft.

Oct 1951

1111 T - RSP

RESERVOIRS — Wyoming

Holland Reservoir
Leeds Creek

owner: WM Buckley
Cokeville, Wyo

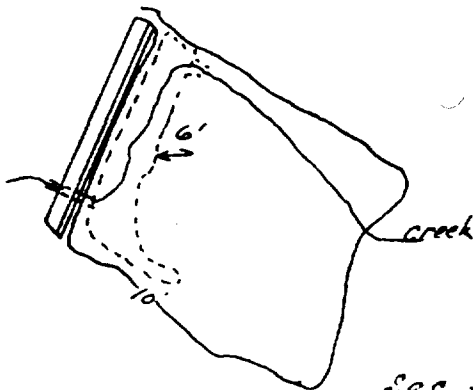

Scale 1" = 500'

Sec 33 T23N R119W

Elev. Outlet = 0
Elev. Spillway = 10'
Elev top of dam = 19'

<u>Elev.</u>	<u>Acres</u>	<u>Ave.</u>	<u>Ac.Ft.</u>	<u>Total</u>
0	0			
		0.8	4.8	
6'	1.6			
		4.2	24.8	29.6
10'	10.8			

Remarks:

Original filing called for capacity of 65,320 ac.ft. New outlet pipe is now delivered at dam site to replace old outlet.

Oct 1951

W.N.J. — B.S.R.

RESERVOIRS - Wyoming

owner: Continental Livestock Quealy Reservoir
 David Mau Mgr Birch Creek
 Cokeville Wyo

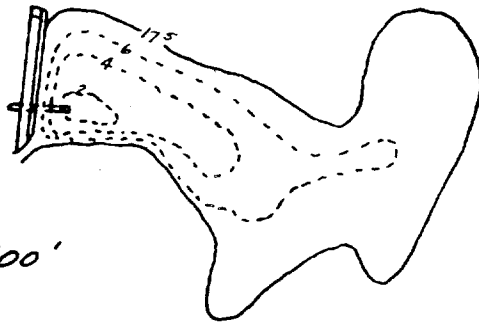

1" = 500'

Tr 69 T25N R119W
 ↳ Sec 25

Elev. Outlet = 0

Elev W.S. = 4'

Elev. Spillway = 17.5'

Elev top of dam = 21'

<u>Elev.</u>	<u>Acres</u>	<u>Ave.</u>	<u>Ac.ft.</u>	<u>Total</u>
0	0	.10	.2	
2	0.2	1.00	2.0	
4	1.8	3.00	6.0	
4	4.2	7.75	89.2	97.4 ac.ft.
17.5	11.3			

Remarks:

Adjudicated Capacity: 97.1 ac.ft.

Oct. 1951

W.M.J. - B.S.P.

RESERVOIRS -- WYOMING

Buyer Creek
~~West Fork of South Fork Twin Cr.~~



Owner - A. J. Angelo
 Box 409
 Kemmerer, Wyo.

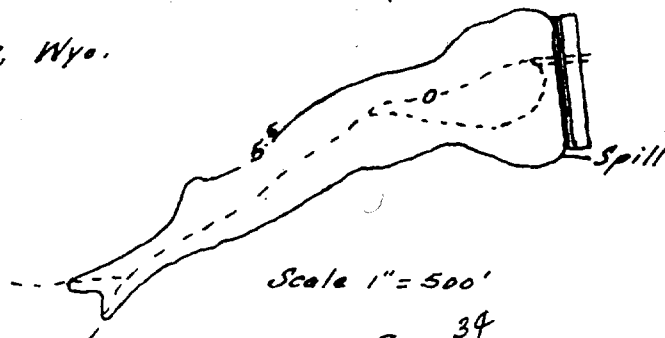

Scale 1" = 500'
 Sec ³⁴ 72 T20N R117W (approx)

Elev. outlet = 0
 Elev. w.s. = 0
 Elev. Spillway = 5.5'
 Elev. top of dam = 10'

<u>Elev.</u>	<u>Acres</u>	<u>Average</u>	<u>Ac. Ft.</u>	<u>Total</u>
0	1.0			
		3.8	20.9	20.9
5.5	6.6			

REMARKS:

Mr. Angelo also owns an irrigation reservoir in sec 24 T20N R117W now filled to capacity (estimated at 20 ac. ft.).
 Owner at time of construction (both reservoirs) was John Buyer. Adjudication, if any, unknown by Mr Angelo's son who was contacted on field inspection.

RESERVOIRS — Wyoming

owner — Charles Smith
Box 209
Kemmerer, Wyo.

South Fork Twin Cr



Permit # 3370R
Priority: 10/26/16

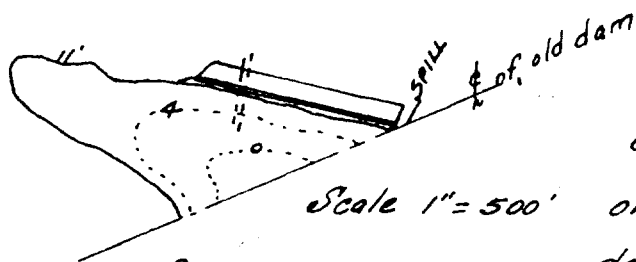

Elev. Outlet = 0
Elev. Spillway = 11'
Elev. W.S. = 4'
Elev. top dam = 17'

Original contents
on basis of old
dam was ~~80~~ ^{84.55} ac.ft.
Mapped portion of
new res. to be added

Elev.	Acres	Ave.	Ac.Ft.	Total
0	0.5	1.3	5.2	5.2
4'	2.1	3.25	22.8	28.0
11'	4.4			
			Plus 80 ^{84.55} ac.ft.	= 108 ¹¹³ ac.ft.

Rickey Reservoir

owner — Charles Smith

Data from Survey and filing in his possession — Reservoir inspected, no changes noted. ?

Permit # 3309R
Priority — July 11, 1916

Sec 5 & 6 T20N R117 W

Contour	Acres	Average	Capacity	Total
88	2.00		5.70	
90	3.70	2.85	35.75	
95	10.60	7.15	94.50	135.95
100	27.20	18.90		

Remarks:

In addition to the above reservoirs, Mr. Smith has constructed a third one in Sec 14, 15, 22 & 23 T21N R117W, now filled to capacity and reported by Mr. Smith to hold 80 ac.ft. (S.C.S.). Not yet filed on.

RESERVOIR - Wyoming

Chalk Creek



Owner: Elgin Jackson
MONTPELIER Ida.

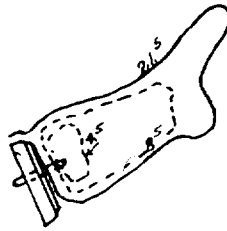

Scale: 1" = 500'

NW $\frac{1}{4}$ Sec 10 T25N R.119W

- Elev. outlet = 0'
- Elev. w.s. = 4.5'
- Elev. Spillway = 21.5
- Elev. top dam = 26.5 ave.

<u>Elev.</u>	<u>Acres</u>	<u>Ave.</u>	<u>Ac. ft</u>	<u>Total</u>
0	0			
4.5	0.25	.12	0.5	
8.5	1.40	.82	3.3	
21.5	2.60	2.00	26.0	29.8

Remarks:

Oct 1951

W.N.S. - B.S.R.

RESERVOIRS

— WYOMING —

CROMPTON RESERVOIR

Pleasant Valley Creek.

<u>Contour</u>	<u>Area</u>	<u>Volume</u>	<u>Total Capacity</u>
6724.0	0	0.1	
6725	.2	29.5	0.1
6730	11.6	107.5	29.4
6735	31.4	251.0	137.1
6740	69.1	420.0	388.1
6745	98.9	582.0	808.1
6750	134.0		1390.1

Spillway apron, bottom of flashboard; elev 6739.72; Cap. 3

Top of piers and crest of flashboards; elev. 6741.20; Cap. 476
ac. ft.

Capacity table from Reclamation Bureau Survey, Aug 3, 1939.

Spillway elevations from U.S.G.S. Nov. 1951

<u>Elev</u>	<u>CAP.</u>
6770	5000
6785	10,000
6795	15,000
6810	25,000
6832	50,000

RESERVOIRS Wyoming

Willow Cr - Sulphur Cr

Heber Reservoir
Sec 36 T13N R119W

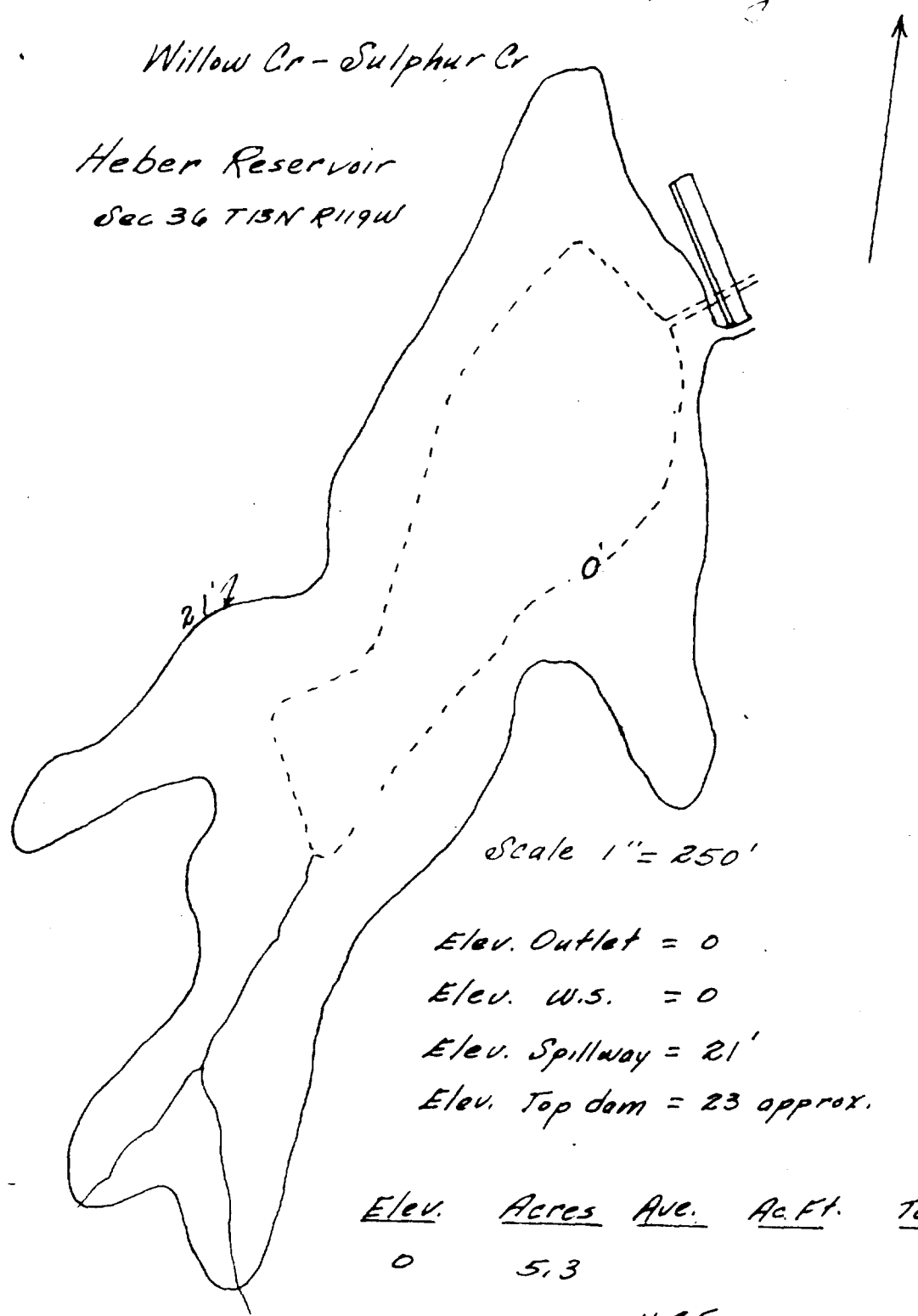

Scale 1" = 250'

- Elev. Outlet = 0
- Elev. W.S. = 0
- Elev. Spillway = 21'
- Elev. Top dam = 23 approx.

<u>Elev.</u>	<u>Acres</u>	<u>Ave.</u>	<u>Ac. Ft.</u>	<u>Total</u>
0	5.3			
		11.45	240	240 ac. ft.
21	17.6			

Sept 1951

W.N.T. - R.S.R.

RESERVOIRS Wyoming

Blake Reservoir

Diversion from Willow Cr.

Owner: Jack Norrell

Fremont, Wt. NWNE 7 T13N R119W

	<u>Elev.</u>	<u>Acres</u>	<u>Average</u>	<u>Ac.Ft.</u>	<u>Total</u>
	76.82	3.18			
			4.38	14.93	
Elev Outlet = 76.5	80.0	5.58			
" Spillway = 95.0			6.79	33.95	
	85.0	8.00			
			8.81	44.05	
	90.0	9.62			
			11.955	59.775	
	95.0	14.29			
					<u>152.705</u>

Surveyed by
Emil Gradert

Application for 3rd enlargement of Kochapelle No 3
ditch Permit # 1988 Eal.

Remarks:

Reservoir is to be built this fall according to
Foreman at ranch.

Sept 1951

W.N.J. & B.S.R.

RESERVOIRS

Utah

NORTH RESERVOIR - (by diversion from Woodruff Cr.)
NW corner SEC. 9 T.9N. R.7E.

	<u>Elev.</u>	<u>Area Acres</u>	<u>Ac. Ft.</u>	<u>Capacity (Ac. Ft.)</u>
	4945	1.13		1.13
			9.90	
	50	2.83		11.03
			24.70	
	55	7.85		37.73
			64.63	
	60	18.00		102.36
Spillway	62 approx.	24.8	42.8	145. Ac. Ft. (approx)
	65	35.08		
	70	54.84		
	75	82.96		
	80	111.82		
	85	143.20		
	90	172.81		
	95	201.32		

Data from plans in office of Utah Water & Power Board.

RESERVOIRS

Utah

Johnson Reservoir - Six-mile Creek

Sec. 25 T13N R9E.

<u>Elev.</u>	<u>Area (ac.)</u>	<u>Volume</u>	<u>Capacity</u>
101.4	0		
		2.18	
105	1.21		2.18 Ac. Ft.
		29.78	
110	10.70		31.96
		89.05	
115	22.92		114.01
		141.25	
120	33.58		257.26
		195.53	
125	44.63		452.79
		244.20	
130	61.05		714.99

Spillway elevation = 125'

Maximum High Water = 126' → Approx. Cap. = 506

Top of dam elev. = 130'

Above data from plans in State Engineer's office

RESERVOIRS — UTAH

Woodruff Cr. Reservoir (Lone Pine)

located 1/2 mile below Birch Creek reservoir
now under construction. (Sec 14 or 20 T9N R6E)

Capacity table from plans dated Feb
4, 1928 in possession of Arthur Dean, Secy Water
Users Assoc. Notation on plans by State
Engineer indicates that application was not
approved because construction started before
approval of plans.

Mr. Dean reports present capacity to be
279 ac. ft.

<u>Elev.</u>	<u>Area</u>	<u>Accum.</u> <u>Ac. Ft.</u>	
100	0	0	corrected
110	2.8	11.0	14.0
120	8.5	47.0	70.5
130	15.0	184.0	188.
140	22.0	369.0	373.0

If present reported capacity is correct:

Spillway elev = approx 135'

Spillway Elevation from U.S.G.S. Survey, Sept 1951

Water Surface to bottom of outlet (by rod) = 10.5'

Assume outlet elev. is 100. (Table above)

Then Water Surface elev. = 110.5'

Spillway elev.:

upstream - 128.2	}	128' ¹ / ₂ ^{over} three rock masonry walls across spillway
center - 127.8		
downstream - 128.4		

From Capacity table, maximum contents = approx 169 ac. ft.

RESERVOIRS - 270.1

Woodruff Town Res.
Woodruff Co
Sec 17 T9N R7E.

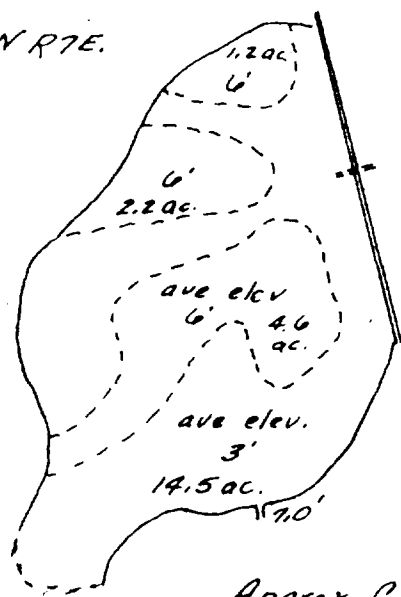

Scale 1" = 500'

Elev Outlet = 0
Elev. Spillway = 7.0
Elev. top of dam = 10.5

Approx. Capacity:

$$(4.6 + 2.2 + 1.2) \times 1 = 8.0$$

$$14.5 \times 4 = 58.0$$

Total 66 Ac. Ft.

Remarks:

Reservoir has filled past two years. Spillway on south side was cut in 1950 to release water. Approximate capacity computed above is based on this temporary spillway.



SPILLWAY - NEPONSET RESERVOIR

		USBR	
6424	1170	PROJECTED CAPACITY	11,272
6426	1279	NEPONSET RES.	13,721
6428	1370		16,370
6430	1456		19,196
6432	1539		22,191
6434	1624		25,354
6436	1700		28,678
6438	1732		32,110
6440	1803		35,645
6442	1866		39,314
6444	1929		43,109

RESERVOIRS
- UTAH -

NEPONSET RESERVOIR
Deseret Livestock Co.

	<u>Contour</u>	<u>Area</u>	<u>Volume</u>	<u>Total volume</u>
	6,400.8	0		0
			6	
	6,403.4	7		6
			104	
	6,405.8	54		110
			1,317	
	6,411.8	385		1,427
			2,940	
	6,414.8	791		4,367
			972	
	6,418.0	829		5,339
			678	
Spillway (1938)	6,418.8	867 *		6,017
			1,074	
	6,420.0	925		7,093
	6,422.0	1042		9,060

7500

* interpolated acreage

Top of sandbags across spillway; Avg Elev. 6,417.8; Cap. 6,900 cuft.
Crest of spillway, bottom of sandbags; Elev. 6,418.0; Cap. 5,850 cuft.

Capacity taken from U.S. Forest Reclamation Survey, 1939.
Sandbags & Spillway elevations from L.S. Survey, Nov 6, 1951

out dam which was assumed to be 'Spring Hollow Res' as adjudicated.

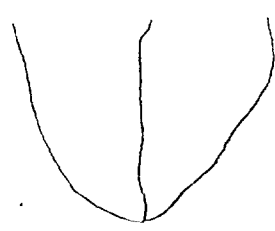

Sept 1951

Saleratus Cr
 Sec 2 T6N R6E
 Deseret Livestock Co.

FEDERAL HIGHWAY - 12000

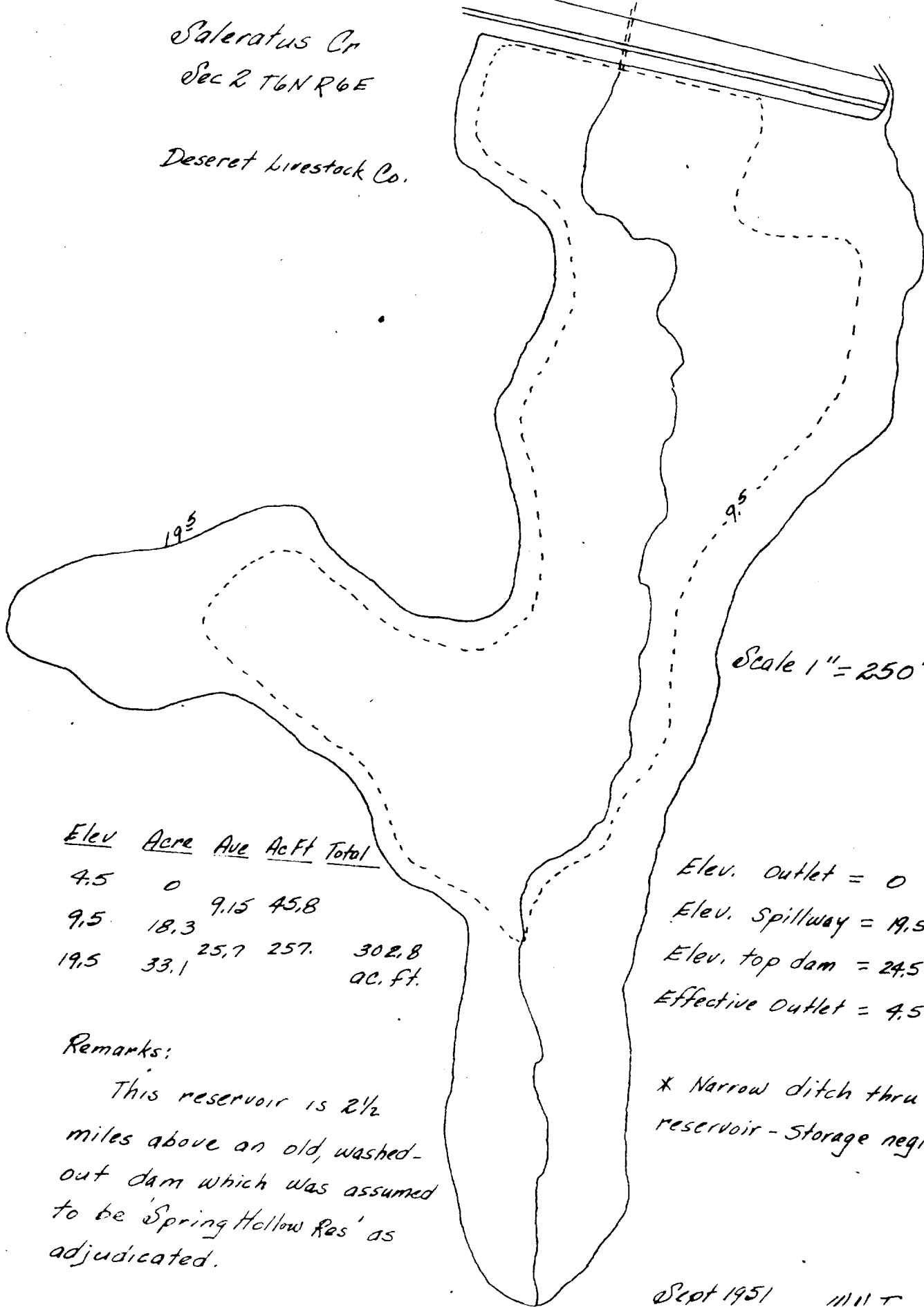

Scale 1" = 250'

Elev	Acre	Ave	Ac.Ft	Total
4.5	0			
9.5	18.3	9.15	45.8	
19.5	33.1	25.7	257.	302.8 ac. ft.

Elev. Outlet = 0
 Elev. Spillway = 19.5'
 Elev. top dam = 24.5'
 Effective Outlet = 4.5' x

Remarks:
 This reservoir is 2 1/2 miles above an old, washed-out dam which was assumed to be 'Spring Hollow Res' as adjudicated.

x Narrow ditch thru reservoir - Storage negligible

Sept 1951 MTT

RESERVOIRS — UTAH

Saleratus Creek

owner: Desert Livestock Co.

Beaver Res.
Sec 2 T6N R6E

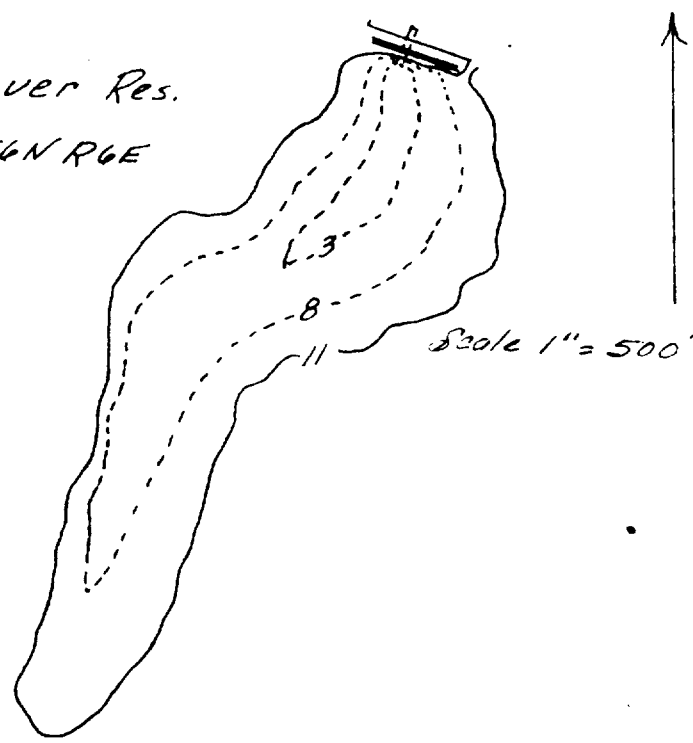

Elev. Outlet = 0'
 Elev. Spillway = 11'
 Elev. Top dam = 15'

<u>Elev</u>	<u>Acres</u>	<u>Ave.</u>	<u>Ac. Ft.</u>	<u>Total</u>
0	0			
3	1.3	65	2.0	
8	8.6	4.95	24.8	
11	17.2	12.9	38.7	65.5 ac.

Remarks:

Location appears to be coincident with original filing on Beaver reservoir. All reservoirs on Saleratus and tributaries are new or have been modified recently - Spillway on this reservoir is in process of completion.

Sept 1951

W.H.J. — B.S.R.

RESERVOIRS → UTAH

owner: Desert Land & Livestock

East Fork Saleratus Creek

Sec. 12 T4N R4E

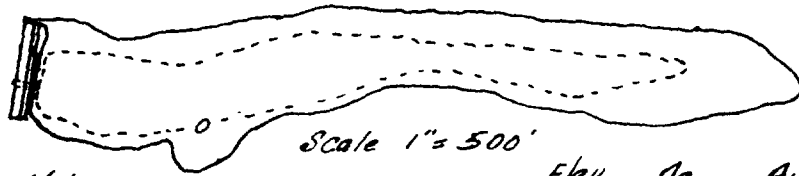

	<u>Elev.</u>	<u>Ac.</u>	<u>Ave.</u>	<u>Ac. Ft.</u>	<u>Total</u>
Elev. Outlet = 0	0	5.2			
Elev. W.S. = 0	0	5.2			
Elev. Spillway = 7.5'	7.5	11.6	8.4	63	63 ac.ft.
Elev. Top dam = 10'					

Saleratus Cr.

Sec 11 T6N R6E

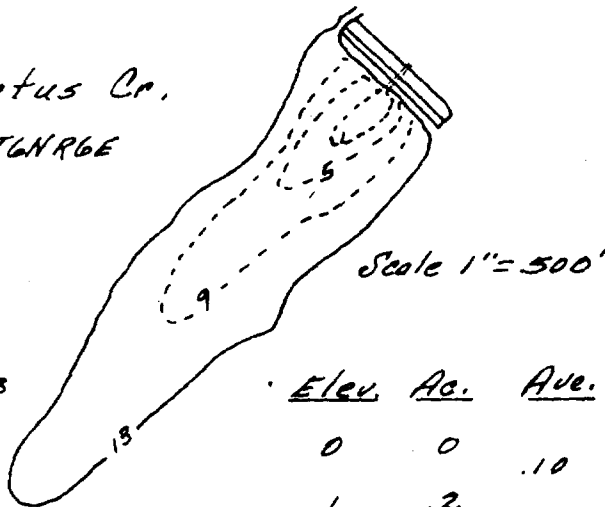

	<u>Elev.</u>	<u>Ac.</u>	<u>Ave.</u>	<u>Ac. Ft.</u>	<u>Total</u>
Elev. Outlet = 0	0	0	.10	.10	
Elev. W.S. = 13					
Elev. Spill = 12.3					
	1	.2	.55	2.2	
	5	.9	2.15	8.6	
	9	3.4	6.65	26.5	37.4 ac.ft.
	13	9.9			

Remarks:

Location only approximate - Both reservoirs are new or modified recently.

Sept 1951

W.N.J. → B.S.R.

RESERVOIR

W. H. T. M.

← North

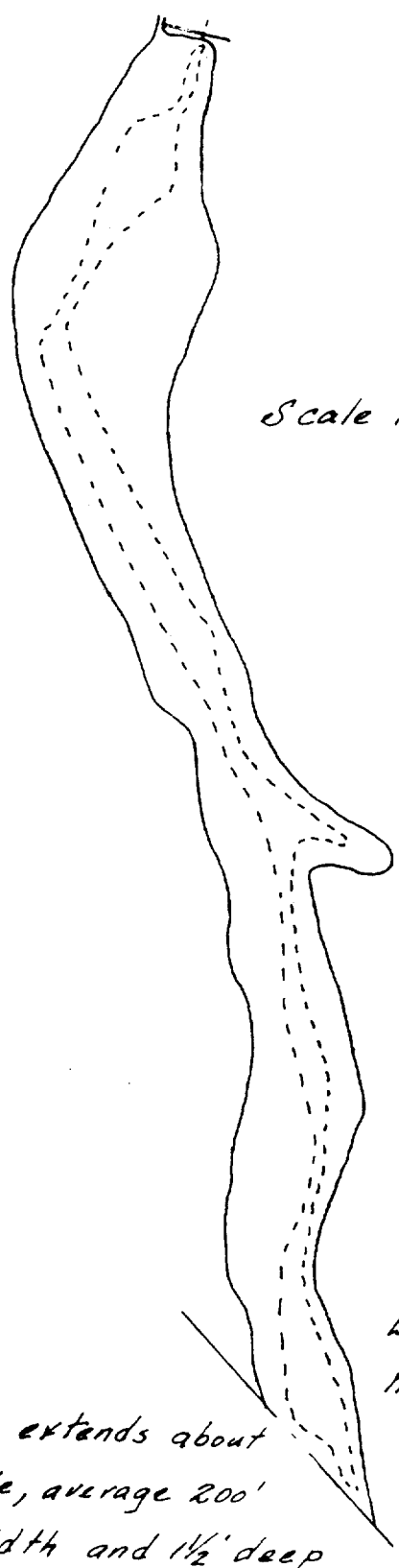

Crane Reservoir
 Duck Cr - Wahsatch Cr - Bear R.

Sec 10 & 11 T6N R7E

Scale 1" = 1,000'

- Elev. Outlet = 0'
- Elev. W.S. = 0'
- Elev. Spillway = 10'
- Elev. Topdam = 13'

Elev.	Acres	Ave. Ac.Ft.	Total
0	30.9	71.4	71.4
10	112.0		

Extension not

mapped: $\frac{2640 \times 200 \times 1.5}{43560} = 18.0 \text{ acft}$

Basin extends about .5 mile, average 200' in width and 1/2' deep during high water

Total Capacity = 732 ac. ft.

Sept 1951

W.H.T. - ASD

RESERVOIR - Idaho

CHEEP CREEK - Sec 36 T135 R45E

Owner: W.G. Lloyd et al.

Elev.	Acres	Average	Ac. Ft.	Total
89	1.25		1.25	1.25
		4.50	18.00	19.25
93	7.75			
		13.87	55.98	74.73
97	20.00			
		23.25	46.50	121.23
99	26.50			
		31.25	93.16	214.83
* 102	36			

* Spillway, original elev. 99', was raised an indeterminate amount believed to be approx. 3'. Capacity curve extended to elev. 102 & additional approx. Contents computed. Filing based on original spillway.

Except as noted above, Contents taken from Engineer's survey (Delbert Smith - Preston, Idaho)

Sept 1951

W.N.J.

RESERVOIR - EDWARDS
 Wood Canyon - Thomas Fork
 Three Reservoirs

Owner: A.A. Covey
 Salt Lake City

Elev. Outlet = 0'
 Elev. W.S. = 2.5'
 Elev. Spillway = 8.0'
 Ave depth Water = 2.0'

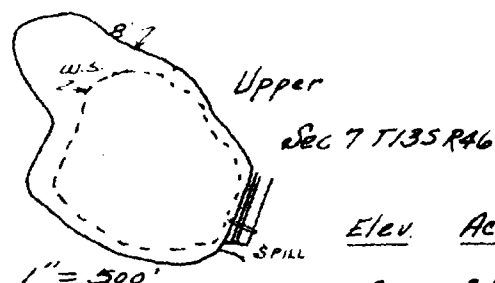

Elev.	Ac.	Ave.	Ac.Ft.	Total
0	3.8	3.8	7.4	
2.0	3.8			
8.0	6.0	4.9	29.4	37.0 ac. ft.

Elev. Outlet = 0'
 Elev. W.S. = 2
 Elev. Spill(2) = 16.5' 1" = 500'

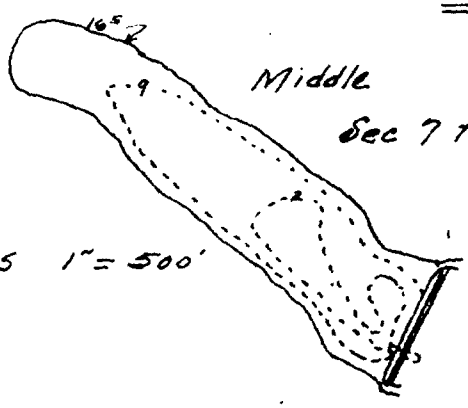

Elev.	Ac.	Ave.	Ac.Ft.	Total
0	0	.55	1.1	
2.0	1.1			
9.0	4.4	2.85	19.8	
16.5	7.5	6.05	45.4	66.3 ac. ft.

Elev. Outlet = 0
 Elev. Spillway = 8' 1" = 500'

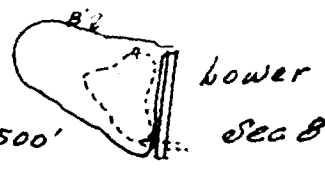

Elev.	Acres	Ave.	Ac.Ft.	Total
0	0	.22	0.9	
4	.45			
8	2.0	1.22	4.9	5.8 ac. ft.

Remarks:

Oct 1951

W.N.J. - B.S.R.

BEAR RIVER COMMISSION

LIBRARY COPY

USGS-3-22

Report # 62

W. N. Jibson

WALLACE N. JIBSON

EXISTING IRRIGATION RESERVOIRS

in

BEAR RIVER BASIN

above

BEAR LAKE

Preliminary Report, not for release to the public, and subject to revision. This report is for restricted use by the Bear River Compact Commission and its Committees and is not to be published, reproduced or circulated, except by the approval of the Director of the U. S. Geological Survey.

Prepared By

W. N. Jibson, Hydraulic Engineer
U. S. Geological Survey

November 28, 1951

50.

1

SEARCHED INDEXED SERIALIZED FILED

EXISTING RESERVOIRS ABOVE BEAR LAKE

At the Bear River Compact Drafting Committee meeting held in Salt Lake City on August 1, 1951, it was recommended that a listing of all existing reservoirs above Bear Lake be included in Article V of the Proposed Compact. A listing of all existing reservoirs as extracted from published adjudications was prepared by the Logan Project Office and presented to the Bear River Compact Engineering Committee at Salt Lake City on August 23, 1951. It was recommended by that Committee that the State Engineers examine their records to insure that all permits, filings, adjudications and decrees, were included and that the Logan Project Office make an examination in the field to check the recorded rights. Since time was limited and because accurate field surveys would be both time consuming and costly, the Committee suggested that the field examinations be limited to making only approximate checks on capacities.

This report has been prepared as a matter of record of the extent of the field examinations made by the Logan Project Office, U. S. Geological Survey.

Using as a guide the adjudication lists supplied by the states, a field examination was made of all listed irrigation and many stock reservoirs. Where feasible, stock reservoirs were examined in order to definitely exclude them from the category of irrigation or dual purpose reservoirs. In addition to the listed reservoirs, quite a number, apparently with incomplete or no filing, were found by checking with other Agencies and with local ranchers.

This summary includes, with a few exceptions, only those reservoirs having outlet works which would permit emptying of contents and use for irrigation. The exceptions are those reservoirs found to be solely for stock, which were adjudicated for stock and irrigation use or without a definite use shown. The majority of stock reservoirs examined were found to be less than 20 acre-feet in capacity.

NAME	SOURCE	LOCATION	DATE OF PRIORITY	CAPACITY IN ACRE-FEET	
				ADJUD.	LOGAN OFFICE SURVEY
Noblitt No. 1	Erwin Cr. by Diversion.	S $\frac{1}{2}$ sec 20 T25N R119W	9/21/07	31.2	34.3 measured.
Noblitt No. 2	Potato Creek	E $\frac{1}{2}$ sec 30 T25N R119W	9/21/07	18.0	8.3 measured.
Noblitt No. 3	Potato Creek	NE $\frac{1}{4}$ sec 30 T25N R119W	9/25/09	24.5	4.4 measured.
Noblitt No. 4	Erwin (Diverted to No. 1 Res.)	N $\frac{1}{2}$ sec 19 T25N R119W	9/21/07	10.5	6 estimated.
Noblitt	Poison Creek	E $\frac{1}{2}$ sec 2 T24N R120W	8/2/09	21.5	10.9 measured.
Noblitt	" "	Sec 1 T24N R120W	8/2/09	9.4	7.4 measured.
Noblitt	" "	W $\frac{1}{2}$ sec 2 T24N R120W	8/2/09	11.2	9.3 measured.
Hawkins	Hawkins Cr. - Smiths Fork	Sec 20 T 26N R118W	6/29/10	14.1	Abandoned.
Frederick No. 1	Trail Cr. - Sublette Cr.	Sec 1 T23N R119W	6/3/10	1.32	Washed out, abandoned.
Stoffers	" "	Sec 1 T23N R119W	8/16/10	3.74	Washed out, abandoned.
Holland	Leeds Creek	Sec 33 T23N R119W	10/21/11	65.32	29.6 measured.
Ellen	Antelope Creek	SW $\frac{1}{4}$ sec 4 T22N R119W	6/1/14	12.8	2 estimated.
Frame	Spring - Rock Cr. - Twin Cr.	Sec 9 T23N R118W	9/27/27	1.27	Stock reservoir.
Rich	Hartley Creek - Twin Cr.	Sec 21 T22N R117W	10/3/14	72.5	Washed out, abandoned years ago.
Gus	Dipper Cr. - Hartley Cr. - Twin Cr.	Sec 13 T22N R118W	8/4/09	20	Apparently nonexistent.
Anna	Linden-W.Fk. " "	Sec 24 T22N R118W	8/4/09	12	Apparently nonexistent.
E. W. Smith	Spring Cr. Bridger Cr.	Sec 34 T20N R120W	10/20/14	20.7	Apparently stock if existent.
Quealy	Birch Creek	Sec 25 T25N R119W	10/12/14	97.1	97.4 measured.
Angelo	South Fork Twin Cr.	Sec 27 ⁶ 21 ²⁰ 117	?	?	20 estimated.
Angelo	Buyer Cr. - Twin Cr.	Sec 12 ³⁴ 12 ¹¹⁷ T21N R118W	9/4/47	29.54	20.9 measured.
Chas. Smith	South Fork Twin Cr.	NE $\frac{1}{4}$ sec 22 T21N R117W	Being Filed 80.		20 (Capacity from owner & SCS)

NAME	SOURCE	LOCATION	DATE OF PRIORITY	CAPACITY IN ACRE-FEET	
				ABSUD.	LOGAN OFFICE SURVEY
Richey (C. Smith)	South Fork Twin Creek	Sec 5 & 6 T20N R117W	7/11/16	135.95	135.95 from filing.
Chas. Smith	South Fork Twin Creek	Sec 27 T21N R117W	10/25/16	81.55	113 from filing plus enlargement
Alfred Thoman	Gooseberry Draw - Twin Creek	NNE sec 7 T21N R117W	9/16/17	98.00	98.00 from U.S.G.S. records, no filing.
E. H. Jackson	Chalk Cr.	NW 1/4 sec 10 T25N R119W			29.8 measured.
Crompton	Pleasant Valley Cr. Bear R.	Sec 9 T15N R120W	1/20/28	90.00	
"	" " "	"	11/13/34	157.98	475 from U.S.G.S. Survey
"	" " "	"	4/25/40	208.68	
Pacific Fruit	Bear River	Sec 21 T15N R120W	1/19/11	457.49 118.0	for production, no longer used.
Heber	Trib. to Willow Cr.	Sec 36 T13N R119W	8/21/06	270.0*	140 measured.
Blake	Willow Cr. by Diversion.	NWNE 7 T13N R119W	12/15/49	152.00	Filed, to be built this fall.
Rasmussen	Springs - Yellow Cr.	Sec 2 T14N R121W	1/4/17	8.25	Stock reservoir.
Dock (D. Boise)	West Sheep Creek	Sec 35 T22N R118W	7/29/08	11.0	Reported stock use for many years. Not inspected.
Morgan	Unnamed - Rock Cr. - Twin Cr.	Sec 15 T22N R118W	6/28/16	37.15	Reported stock use for many years. Not inspected.
East (A.V. Quinn)	Sulphur Cr. - Yellow Cr.	Sec 6 T14N R120W	9/20/07	25.0	Reported most of dam washed out. Stock use only. Not inspected.
Myers	Null Cr. by div. from Mill Cr.	Sec 13 T13N R120W	3/28/39	556.5	140 est. present cap. Not completed.
Painter	Pleasant Valley Cr.	Sec 31 T16N R119W	12/7/43	167.61	167.61 from filing. Built as specified.
Chesney	Thomas Canyon - Bear River	Sec 11 T15N R121W		128.35	Reported washed out, abandoned for many years. Not inspected.
Maninfior	Spring Cr. - Bear River	Tr 121 T25N R119W	10/31/45	9.76	9.76 from filing. Power and Irrigation.
Martin (Noblitt)	Pine Cr. & Sublette Cr.	Sec 6 T24N R118W	11/8/44	1.25	1.25 Not inspected.

* 270.0 Permit; 388.5 mapped (State Engineer's record).

Wyoming (Cont'd.)

IRRIGATION RESERVOIRS

NAME	SOURCE	LOCATION	DATE OF PRIORITY	CAPACITY IN ACRE-FEET	
				ADJUD.	LOGAN OFFICE SURVEY
Larson (Noblitt)	Pine Cr. - Smiths Fork	Sec 11 T24N R119W	5/28/43	3.81	3.81 Not inspected.
Hamilton	Hamilton Spring Cr.	Sec 11 T25N R119W	5/29/04	3.75	Evidently stock. Not inspected.
			State Total	1,715.99	1,715.76 Includes only circled amounts

Sulphur Cr. Res. Co. Sulphur Cr Sec 27 T14N R119W 2/14/50 4,104.13 * Not constructed; Good standing to 12/31/53
 * Not included in Totals

EXISTING RIGHTS

- 1,744.76 Logan Office Survey (1951)
- 3.1 Noblitt #1 - To Check Adjudication
- 0.3 Quealy " " "
- 20.0 Angelo (So. Fk) Unadjudicated
- 80.0 Chas Smith (So Fk) "
- 17.51 Crompton - To Check Adjudic.
- + 152.70 Blake - Built 1951-54
- + 416.5 Myers - Enlarged 1951-54
- 29.8 E.H. Jackson - Unadjudicated

EXISTING RESERVOIRS
 (Black check mark L)

2,293.35 ac-ft

2,163.25 Rounded to 2,150 in Bear R. Compact

NAME	SOURCE	LOCATION	DATE OF PRIORITY	CAPACITY IN ACRE-FEET	
				ADJUD.	LOGAN OFFICE SURVEY
North	Woodruff Cr. by Diversion	NW ¹ sec 9 T9N R7E	1899	55.0 ✓	145 * from Utah Water & Power B
Johnson	Six Mile Cr.	Sec 25 T13N R7E	1881 ?	717.0	506 ✓ Approx. (Rebuilt)
Little Creek	Little or Randolph Cr.	Sec 25 T11N R6E	1920	614.0	614 ✓ from filing.
Birch Cr. ^(Lone Pine #2)	Birch Cr. - Woodruff Cr.	Sec 19 T9N R6E	1884 -	2256.0	2256 ✓ Filing (Under const.)
Lone Pine #1	Birch Cr. - Woodruff Cr.	Sec 19 or 20 T9N R6E		165.0	169 ✓ Approx.
Woodruff Town	Woodruff Creek	Sec 17 T9N R7E	1899	126.0	66. (600) ** Right to fill 10 times yearly.
Neponset	Bear River	Sec 34 & 35 T8N R8E	8/28/05	6000.0	6900 ✓ Present spillway from U.S.E.R.
Spring Hollow	Saleratus Cr.	Sec 25 T7N R6E	1873	Est. 212	Abandoned dike located.
Beaver	Saleratus Cr.	Sec 2 T6N R6E -	1873	Est. 800	303 ✓ measured (lower res.)
Deseret L. Co.	Saleratus Cr.	Sec 2 T6N R6E -			65.5 ✓ measured.
Deseret L. Co.	Saleratus Cr.	Sec 11 T6N R6E -			37.1 ✓ measured.
Deseret L. Co.	Saleratus Cr. (East Fk.)	Sec 12 T6N R6E -			13.0 ✓ measured.
Crane	Duck Cr. - Wasatch - Yellow	Sec 10 & 11 T6N R7E	1900	Est. 668	730 ✓ measured.
Hopkins, Rees	Dry Wash	Sec 6 T9N R8E	1901	1990 15.4	75 ✓ estimated.
				11,448.0	12,525.9
				11,448.0	12,525.9

** - 594.0 Unadjusted Total
 * - 90.0 Woodruff Town R. adj. to one filling
 * North R. to Adjudication
 State Total

2160
 324
 11932

14416
 - 324
 14,092

11,841.90 af

→ Recognized in Compact: 11,850 af.
 (Rounded)

Dept.
 on classif.
 of 16th

includes approx 650
 acft. in res. without
 adjudication
 11,931.90
 11,841.90 ← Lt. Compact

IDAHO

IRRIGATION RESERVOIRS

NAME	SOURCE	LOCATION	DATE OF PRIORITY	CAPACITY OF ACRE-FEET	
				ADJUD.	LOGAN OFFICE SURVEY
Sheep Creek	Sheep Creek	Sec 36 T13S R45E		121.33	215 Approx.; dam raised.
Covey	Wood Canyon	SW $\frac{1}{4}$ sec 8 T13S R46E			5.8 measured.
Covey	Wood Canyon	SE $\frac{1}{4}$ sec 7 T13S R46E			66.3 measured.
Covey	Wood Canyon	SE $\frac{1}{4}$ sec 7 T13S R46E			37.0 measured.
State Total				121.33	324.1 - 0/10
Three-State Totals				14,315.32	14,594.76 - includes right of Woodruff

Approx ²³¹⁷ ~~1908~~ ac.ft. existing. Capacity of later dated rights than 1911 storage rights. 1894

town (66 ac ft) to fill tan tracts yearly
If 660 reduced to 66.

14,594.76
- 660.
+ 66.

14,000.76

September 11, 1951

GROUP II: Reservoirs located within the drainage basin of the Bear River in Rich County below the Stewart Inn.

NAME	SOURCE OF SUPPLY	LOCATION	DATE OF PRIORITY OR DATE OF APPLICATION	CAPACITY	USE	CONSTRUCTED OR PENDING CONSTRUCTION
Darrell's Dam	Laketown Big Creek	Situated N48°00'W 3275 ft. from SE Cor. Sec. 35 T13N R6E SLB&M	1891	353.70 ac.-ft.	Irrigation & Stock Watering	Constructed under a decreed right
Falula Spring	Falula Spring trib- utary to Bear Lake	SW $\frac{1}{4}$ Sec. 9 T13N R6E SLB&M	1870	0.6 ac.-ft.	Irrigation	Constructed under a diligence right
North Eden	North Eden Creek which is tributary to Bear Lake	NW $\frac{1}{4}$ NW $\frac{1}{4}$ Sec. 2 T14N R7E SLB&M	1880	0.1 ac.-ft.	Irrigation	Constructed under a diligence right
Upper North	North Eden Creek which is tributary to Bear Lake	NE $\frac{1}{4}$ NE $\frac{1}{4}$ Sec. 2 T14N R8E SLB&M	1880	473.7 ac.-ft.	Irrigation	Constructed under a diligence right
South Eden	South Eden Creek which is tributary to Bear Lake	NE $\frac{1}{4}$ NW $\frac{1}{4}$ Sec. 26 T14N R6E SLB&M	1880	143.8 ac.-ft.	Irrigation	Constructed under a diligence right

*Group I Total: 11,969.0 excluding Stock-water
reservoirs and those
around periphery of
Bear Lake. (Group II last page)*

September 11, 1951

NAME	SOURCE OF SUPPLY	LOCATION	DATE OF PRIORITY OR DATE OF APPLICATION	CAPACITY	USE	CONSTRUCTED OR PENDING CONSTRUCTION
Dry Canyon	Unnamed Wash	Sec. 4 T10N R6E SLB&M	Aug. 3, 1945 but reservoir was completed Oct. 1941	9.2 ac.-ft.	Stock Watering	Constructed under a pending application
Higgins Hollow	Unnamed Wash	Sec. 30 T10N R7E SLB&M	Aug. 3, 1945 but reservoir was completed Nov. 1941	14.2 ac.-ft.	Stock Watering	Constructed under a pending application
Upper Sage Hollow	Unnamed Wash	Sec. 34 T10N R6E SLB&M	Aug. 3, 1945 but reservoir was completed June 18, 1942	6.843 ac.-ft.	Stock Watering	Constructed under a certificated right
Little Long Hill	Unnamed Wash	Sec. 5 T9N R7E SLB&M	Aug. 6, 1945 but reservoir was completed Nov. 1941	9.2 ac.-ft.	Stock Watering	Application lapsed
Limestone	Unnamed Wash which is tributary to Bear River	Sec. 14 T10N R6E SLB&M	Aug. 6, 1945 but reservoir was completed Oct. 1941	4.7 ac.-ft.	Stock Watering	Constructed under a pending application
Sage Hollow	Unnamed Wash which is tributary to Bear River	Sec. 1 T9N R6E SLB&M	Aug. 6, 1945 but reservoir was completed Oct. 1941.	39.5 ac.-ft.	Stock Watering	Application Lapsed
State Line	Dry Hollow which is tributary to Bear River	Sec. 5 T10N R8E SLB&M	Aug. 31, 1945 but reservoir was completed Nov. 7, 1944	1.0 ac.-ft.	Stock Watering	Constructed under a pending application
South Big Creek #2	Big Creek, which is tributary to Bear River	Sec. 14 T10N R6E SLB&M	Aug. 31, 1945 but reservoir was completed July 1942	24 ac.-ft.	Stock Watering	Constructed under a pending application
South Big Creek #1	Big Creek, which is tributary to Bear River	Sec. 21 T10N R6E SLB&M	Aug. 31, 1945 but reservoir was completed July 15, 1942	22.0 ac.-ft.	Stock Watering	Constructed under a pending application
Broad Hollow	Unnamed Wash	Sec. 22 T9N R6E SLB&M	Aug. 31, 1945 but reservoir was completed June 1941.	25.0 ac.-ft.	Stock Watering	Constructed under a pending application

September 11, 195.

NAME	SOURCE OF SUPPLY	LOCATION	DATE OF PRIORITY OR DATE OF APPLICATION	CAPACITY	USE	CONSTRUCTED OR PENDING CONSTRUCTION
Spikeman Spring	Spikeman Spring tributary to Salaratus Creek	Sec. 24 T8N R6E SLB&M	1873	1.0 ac.-ft.	Domestic, Irrigation and stock watering	Constructed under diligence right
Neponset	From Bear River diversion in Wyoming and Alkali, Murphy Hollow and Stacey Water Sources in Utah	Secs. 34 & 35 T8N R8E SLB&M	August 28, 1905	Originally de- signed for 1871.0 ac.-ft. but with present estimated capa- city of 6000 ac.-ft.	Irrigation	Constructed under Wyoming right through Diversion through Chapman Canal
Spring Hollow	Salaratus Creek	Sec. 25 T7N R6E SLB&M	1873	Capacity esti- mated at 212.0 ac.-ft.	Irrigation	Constructed under a diligence right
Beaver	Salaratus Creek	Sec. 2 T6N R6E SLB&M	1873	Estimated capa- city 800 ac.-ft.	Irrigation	Constructed under a diligence right
Crane	Duck Creek, trib- utary to Wahsatch Creek, tributary to Yellow Creek, trib- utary to Bear River	Secs. 10 and 11 T6N R7E SLB&M	1900	Estimated capa- city 668 ac.-ft.	Irrigation	Constructed under a diligence right
Cut Off	Unnamed Wash	Sec. 8 T9N R6E SLB&M	August 31, 1945, but reservoir was completed June 5, 1941	50 ac.-ft.	Stock Watering	Constructed under a pending application
Dry Basin	Unnamed Wash	Sec. 11 T9N R6E SLB&M	Aug. 31, 1945, but reser- voir was completed June 10, 1942	14.8 ac.-ft.	Stock Watering	Constructed under a pending application
Dairy Reservoir	Unnamed Wash	Sec. 11 T9N R5E SLB&M	Aug. 3, 1945 but reser- voir was completed May 1941	6.774 ac.-ft.	Stock Watering	Constructed under a certificated right

(1)

RESERVOIRS LOCATED IN UTAH, WHICH HAVE BEEN
CONSTRUCTED UNDER A PENDING APPLICATION, OR
WHICH HAVE BEEN CONSTRUCTED UNDER AN EXIST-
ING RIGHT

September 11, 1951

GROUP I. Reservoirs located within the drainage basin of the Bear River in Rich County above the Stewart Dam.

<u>NAME</u>	<u>SOURCE OF SUPPLY</u>	<u>LOCATION</u>	<u>DATE OF PRIORITY OR DATE OF APPLICATION</u>	<u>CAPACITY</u>	<u>USE</u>	<u>CONSTRUCTED OR PENDING CONSTRUCTION</u>
North	Woodruff Creek	NW ¹ / ₄ Sec. 9 SW ¹ / ₄ Sec. 4 NE ¹ / ₄ Sec. 8 T9N R7E SLB&M	1899	55.0 ac.-ft.	Irrigation	Constructed under Decreed Right
Johnson	Six-Mile Creek	Sec. 25 T13N R7E SLB&M	Date of priority is date of application	717.0 ac.-ft.	Irrigation & Stock Watering	Being constructed and en- larged under a change appli- cation and pending application
Little Creek	Little or Randolph Creek	Sec. 25 T11N R6E SLB&M	1920 - Priority of application		Irrigation & Stock Watering	Has been constructed under pending application
Birch Creek	Birch Creek, a tributary to Woodruff Creek	Sec. 19 T9N R6E SLB&M	Priority of original flow right, 1884, which is being transferred to a storage right under a pending application.	2256.0 ac.-ft.	Irrigation	Is being constructed at present time.
Woodruff Town	Woodruff Creek	Sec. 17 T9N R7E SLB&M	1899	126.0 ac.-ft.	Irrigation with a right to fill 10 times each year, with total storage of 1260.0 ac.-ft.	Constructed under a Decreed Right
Beaver Pond	Beaver Pond Spring which is tributary to Birch Creek, which is tributary to Woodruff Creek	Sec. 16 T9N R5E SLB&M	1895	2.5 ac.-ft.	Stock Watering	Constructed under a Diligence Right

RESERVOIRS

Potato Creek & Erwin Cr.

owner: J.D. Noblitt

Cokeville, Wyo

Elev Outlet = 0

Elev. W.S. = -1.5

Elev. Spill = 4

Noblitt #3

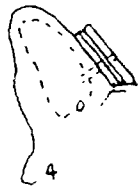

1" = 500'

Tr 53 T25N R119W

↳ sec 29 R.30



Elev	Acres	Ave.	Ac Ft.	Total
0	.6			
4	1.6	1.1	4.4	4.4 ac.ft.

Noblitt #2



Elev. Outlet = 0'

Elev. W.S. = 9.

Elev. Spill = 9.

1" = 500'

Tr 56 T25N R119W

↳ sec 30 (0.2 mi above #3)

Elev.	Acres	Ave	Ac Ft.	Total
0	0.1			
4	0.9	0.5	2.0	
9	1.7	1.3	6.3	8.3 ac.ft.

Noblitt #1

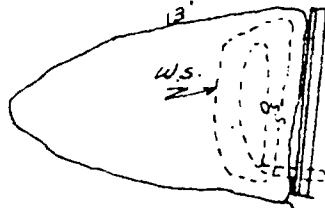

Elev. Outlet = 0'

Elev. W.S. = 5.5'

Elev. Spillway = 13'

Elev Top dam = 17'

1" = 500'

8 1/2 Sec 20

Tr 59 T25N R119W

This reservoir in Wash between Potato and Erwin Creeks and is filled by diversion pipe from Noblitt #4 on Erwin Cr.

Elev.	Acres	Ave	Ac Ft.	Total
0	0.5			
5.5	1.5	1.00	5.5	
13.	6.2	3.85	28.8	34.3 ac.ft.

Remarks:

Noblitt #4, Erwin Cr, is used only as a diversion reservoir to fill Noblitt #1. Field inspection indicates it's listed capacity of 10.5 ac.ft. is higher than actual capacity. Estimated 6 ac.ft. Potato Cr. reservoirs (Noblitt #2 & #3) are considerably smaller than adjudicated.

Oct 1951

W.N.J. vs B.S.R.

RESERVOIRS

Cokeville

Poison Creek

3 reservoirs

owner: J. D. Noblitt
Cokeville Wyo.

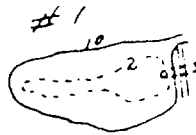

Scale 1" = 500'
Sec 2 T24N R120W

Elev. Outlet = 0
Elev. W.S. = 2'
Elev. Spill = 10'
Elev. Top dam = 13' approx.

Elev.	Acres	Ave	Ac. Ft.	Total
0	0	.25	.50	
2'	.5	1.10	8.8	9.3 ac. ft.
10'	1.7			

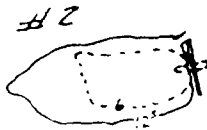

Scale 1" = 500'
E² Sec 2 T24N R120W
half mile below #1

Elev. Outlet = 0
Elev. W.S. = 6'
Elev. Spillway = 12.5'
Elev. top dam = 14'

Elev.	Acres	Ave	Ac. Ft.	Total
0	0	.4	2.4	
6'	.8	1.3	8.5	10.9 ac. ft.
12.5'	1.8			



Scale 1" = 500'
Sec 1 T24N R120W
Half mile below #2

Elev. outlet = 0
Elev. W.S. = 9'
Elev. Spillway = 11'
Elev. Top dam = 13'

Elev.	Acres	Ave.	Ac. Ft.	Total
0	0	.18	0.9	
5'	.35	1.08	6.5	7.4 ac. ft.
11'	1.8			

Remarks:

1944 listing includes one reservoir on Poison Creek
with Capacity of 21.5 ac. ft.

Oct 1951

W.N.J. & B.S.R.

FEUER 1113 - Hydrology

Holland Reservoir
Leeds Creek



owner: W M Buckiey
Cokeville, Wyo

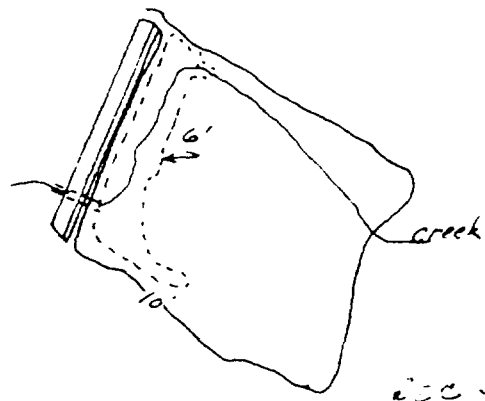

Scale 1" = 500'

SEC 33 T83N R119W

Elev. Outlet = 0
Elev. Spillway = 10'
Elev top of dam = 19'

<u>Elev.</u>	<u>Acres</u>	<u>Ave.</u>	<u>Ac. Ft.</u>	<u>Total</u>
0	0			
		0.8	4.8	
6'	1.6			
		6.2	24.8	29.6
10'	10.8			

Remarks:

Original filing called for Capacity of 65.32 ac. ft. New outlet pipe is now delivered at dam site to replace old outlet.

Oct 1951

W.M.J. - B.S.R.

RESERVOIR

OWNER: Continental Livestock Quealy Reservoir
 David Mau Mgr Birch Creek
 Cokeville Wyo

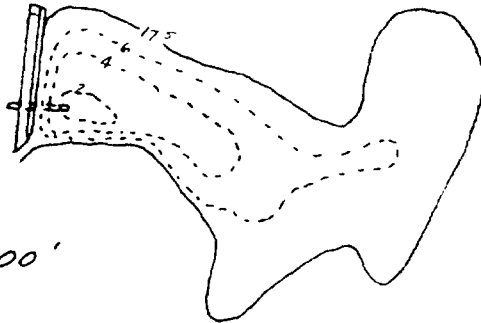
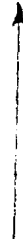

1" = 500'

Tr 69 T25N R119W
 ↳ Sec 25

Elev. Outlet = 0

Elev W.S. = 4'

Elev. Spillway = 17.5'

Elev top of dam = 21'

Elev.	Acres	Ave.	Ac.ft.	Total
0	0	.10	.2	
2	0.2	1.00	2.0	
4	1.8	3.00	6.0	
4	4.2	7.75	89.2	97.4 ac.ft.
17.5	11.3			

Remarks:

Adjudicated Capacity: 97.1 ac.ft.

Oct. 1951

W.N.J. — B.S.P.

Buyer Creek
~~West Fork of South Fork Twin Cr.~~



Owner - A. J. Angelo
 Box 409
 Kemmerer, Wyo.

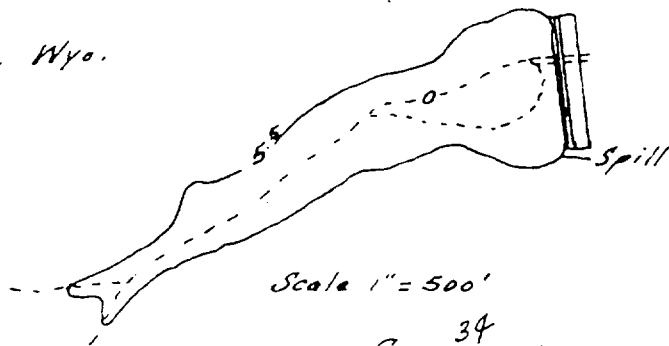

Scale 1" = 500'
 Sec ³⁴ T2N R¹¹⁷W[?] (approx)

- Elev. outlet = 0
- Elev. w.s. = 0
- Elev. Spillway = 5.5'
- Elev. top of dam = 10'

<u>Elev.</u>	<u>Acres</u>	<u>Average</u>	<u>Ac. Ft.</u>	<u>Total</u>
0	1.0	-	-	-
		3.8	20.9	20.9
5.5	0.6			

REMARKS:

Mr. Angelo also owns an irrigation reservoir in sec 24
 T20N R¹¹⁷W now filled to capacity (estimated at 20 ac. ft.).
 Owner at time of construction (both reservoirs) was John
 Buyer. Adjudication, if any, unknown by Mr Angelo's son who
 was contacted on field inspection.

Oct 1951

N.N.J. — B.S.R.

owner - Charles Smith
 Box 209
 Kemmerer, Wyo.

South Fork Twin Cr



Permit # 3370R
 Priority: 10/26/16

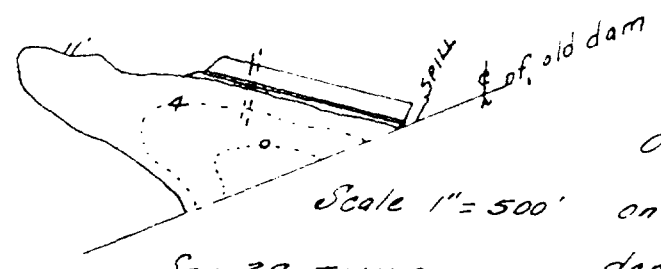

Elev. Outlet = 0
 Elev. Spillway = 11'
 Elev. W.S. = 4'
 Elev. top dam = 17'

Original contents
 on basis of old
 dam was ~~80~~ ^{84.55} ac.ft.
 Mapped portion of
 new res. to be added.

Elev.	Acres	Ave.	Ac. Ft.	Total
0	0.5	1.3	5.2	5.2
4'	2.1	3.25	22.8	28.0
11'	4.4			
			84.55	113
			Plus 20 ac.ft.	133

Fickey Reservoir

owner - Charles Smith

Data from Survey and filing in his possession - Reservoir inspected, no changes noted.

Permit # 3309R
 Priority - July 11, 1916

Sec 5 & 6 T20N R117W

Contour	Acres	Average	Capacity	Total
88	2.00			
90	3.70	2.85	5.70	
95	10.60	7.15	35.75	
100	27.20	18.90	94.50	135.95

Remarks:

In addition to the above reservoirs, Mr. Smith has constructed a third one in Sec 14, 15, 22 & 23 T21N R117W, now filled to capacity and reported by Mr. Smith to hold 80 ac.ft. (S.C.S.). Not yet filed on.

Oct 1951

W.N.T. - B.S.P.

Chalk Creek

Chalk Creek



Owner: Elgin Jackson
MONTPELIER Ida.

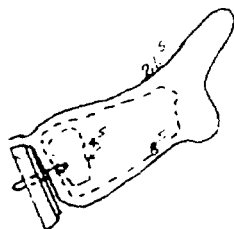

Scale: 1" = 500'

NW 1/4 Sec 10 T25N R.119W

- Elev. outlet = 0'
- Elev. w.s. = 4.5'
- Elev. Spillway = 21.5
- Elev. top dam = 26.5 ave.

<u>Elev.</u>	<u>Acres</u>	<u>Ave.</u>	<u>Ac. ft</u>	<u>Total</u>
0	0			
4.5	0.25	.12	0.5	
8.5	1.40	.82	3.3	
21.5	2.60	2.00	26.0	29.8

Remarks:

Oct 1951

W.N.S. — B.S.R.

RESERVOIRS

— WYOMING —

CROMPTON RESERVOIR

Pleasant Valley Creek.

Contour	Area	Volume	Total Capacity
6704.0	0	0.1	
6735	.3	29.5	6.1
6736	11.4	107.5	29.4
6735	31.7	251.0	137.1
6740	64.1	420.8	358.1
6745	98.9	562.5	508.1
6750	134.5		1390.1

Spillway apron, bottom of flumeours; elev. 6734.0; Cap. 359

Top of pier and crest of flumeours; elev. 6745.0; Cap. 475 ac. ft.

Capacity table from Reclamation Bureau Survey, Aug 3, 1939.

Spillway elevations from U.S.G.S. Nov. 1951

Elev	CAP.
6770	5,000
6785	10,000
6795	15,000
6810	25,000
6832	50,000

RESERVOIR

Willow Cr - Sulphur Cr

Heber Reservoir

Sec 36 T13N R119W

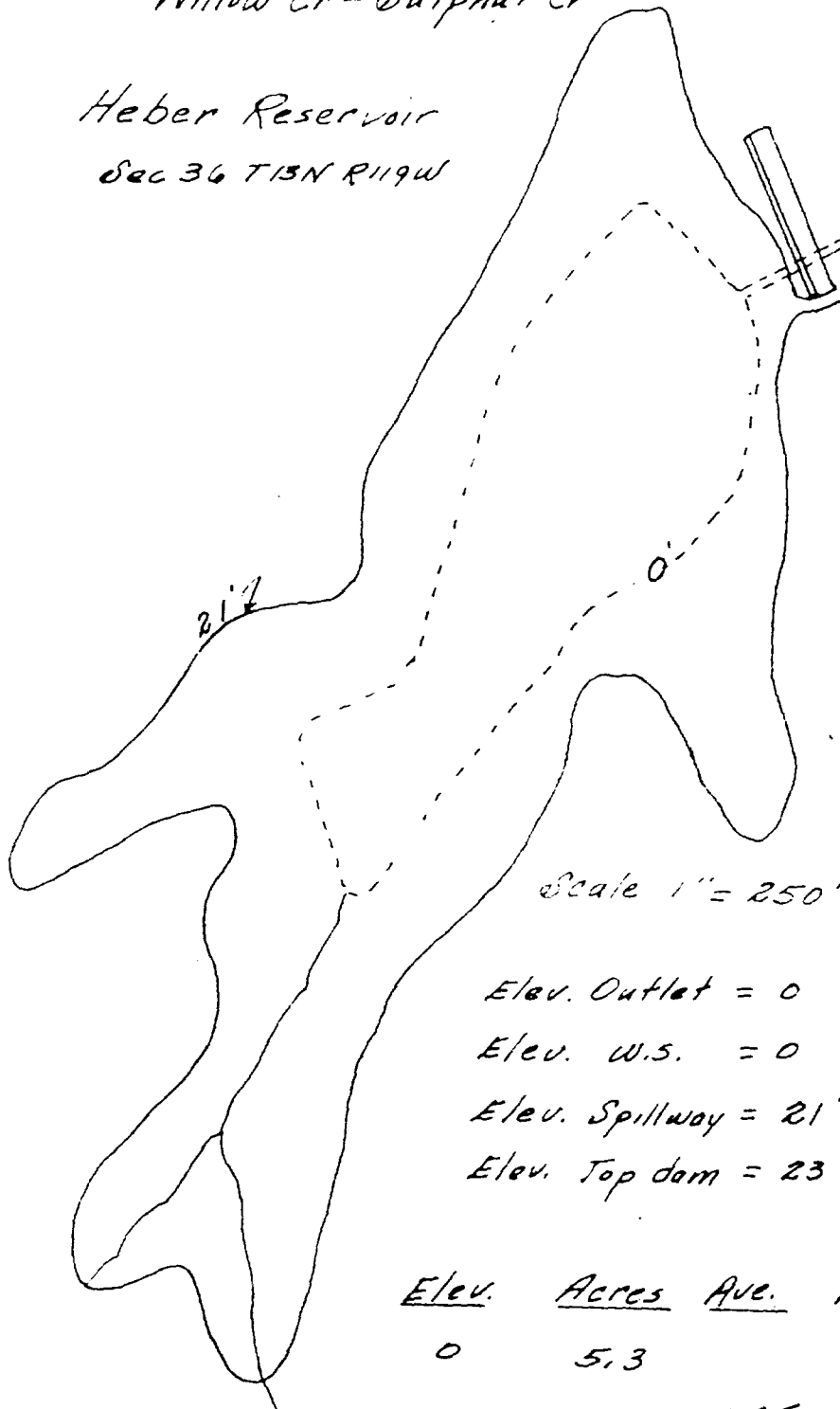

Scale 1" = 250'

Elev. Outlet = 0

Elev. W.S. = 0

Elev. Spillway = 21'

Elev. Top dam = 23 approx.

<u>Elev.</u>	<u>Acres</u>	<u>Ave.</u>	<u>Ac. Ft.</u>	<u>Total</u>
0	5.3			
		11.45	240	240 ac. ft.
21	17.6			

Sept 1951

W.N.T. - B.S.R.

RESERVOIR Capacity

Blake Reservoir

Diversion from Willow Cr.

Owner: Jack Morrell

Fremont, Ut. NWNE 7 T13N R119W

	<u>Elev.</u>	<u>Acres</u>	<u>Average</u>	<u>Ac. Ft.</u>	<u>Total</u>
	76.82	3.18			
			4.38	14.93	
Elev Outlet = 76.5	80.0	5.58			
" Spillway = 95.0			6.79	33.95	
	85.0	8.00			
			8.81	44.05	
	90.0	9.62			
			11.955	59.775	
	95.0	14.29			
					<u>152.705</u>

Surveyed by
Emil Gradert

Application for 3rd enlargement of Kochapelle No 3
ditch Permit # 1988 Ent.

Remarks:

Reservoir is to be built this fall according to
Foreman at ranch.

Sept 1951

W.N. J. - B.S.R.

RESERVOIRS

Utah

NORTH RESERVOIR - (by diversion from Goodcraft Cr.)

NO. 30000 SEC. 9 T9N R7E.

Elev.	Area Acres	Ac. Ft.	Capacity (Ac. Ft.)
47.45	1.13		1.13
		9.90	
50	2.83		11.03
		24.70	
55	7.85		37.73
		64.63	
60	18.00		102.36
62 approx.	24.8	42.8	145.1 Ac. Ft. (approx.)
65	35.35		
70	54.84		
75	82.90		
80	111.82		
85	143.20		
90	172.81		
95	201.32		

Data from plans in office of Utah Water & Power Board.

Oct 1951 WNT

RESERVOIRS

Utah

Johnson Reservoir - Six-mile Creek
Sec. 25 T13N R7E.

<u>Elev.</u>	<u>Area (ac.)</u>	<u>Volume</u>	<u>Capacity</u>
101.4	0		
		2.19	
105	12.1		5.18 Ac. Ft.
		29.78	
110	16.70		31.96
		89.95	
115	22.72		114.01
		141.25	
120	33.58		257.24
		195.53	
125	44.63		452.77
		244.20	
130	61.05		714.97

Spillway elevation = 125'

Maximum High Water = 126' → Approx. Cap. = 506

Top of dam elev. = 130'

Above data from plans in State Engineer's office

RESERVOIRS — UTAH

Woodsruff Cr. Reservoir (same find)

located 1/2 mile below Birch Creek Reservoir
now under construction. (See report of 1948 RUE)

Capacity table from plans dated Feb
4, 1928 in possession of Arthur Dean, Seaf Water
Users Assoc. Notation on plans by State
Engineer indicates that application was not
approved because construction started before
approval of plans.

Mr. Dean reports present capacity to be
279 ac. ft.

<u>Elev.</u>	<u>Area</u>	<u>Accum. Ac. Ft.</u>	
100	0	0	contract
110	2.3	11.0	14.0
120	8.5	67.0	70.5
130	15.0	184.0	188.
140	22.0	369.0	373.0

If present reported capacity is correct:

Spillway elev = approx 135'

Spillway Elevation from U.S.G.S. Survey, Sept 1951

Water Surface to bottom of outlet (by rod) = 10.5'

Assume outlet elev. is 100. (Table above)

Then Water Surface elev. = 110.5'

Spillway elev.:

upstream - 128.2	} ^{20' ave} three rock masonry walls across spillway
center - 127.8	
downstream - 128.4	

From Capacity table, maximum contents = approx 169 ac. ft.

Reservoir

Woodruff Town Res.
Woodruff Co
Sec 17 T9N R7E.

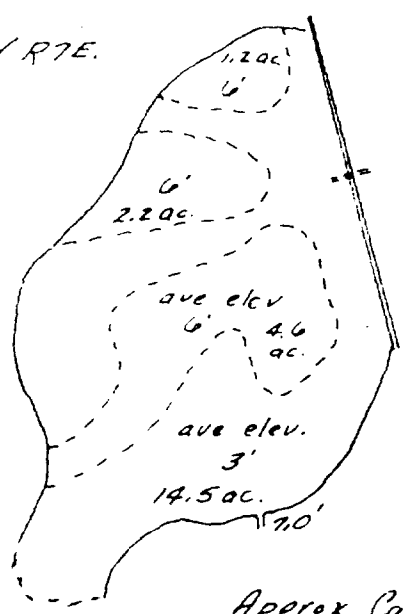

Scale 1" = 500'

Elev Outlet = 0
 Elev. Spillway = 7.0
 Elev. top of dam = 10.5

Approx. Capacity:
 $(4.6 + 2.2 + 1.2) \times 1 = 8.0$
 $14.5 \times 4 = 58.0$
 Total 66 Ac.Ft.

Remarks:

Reservoir has filled past two years. Spillway on south side was cut in 1950 to release water. Approximate capacity computed above is based on this temporary spillway.

Oct 1951 W.N.J. - B.S.R.



SPILLWAY - NEPONSET RESERVOIR

		USBR	
6424	1170	PROJECTED CAPACITY	11,272
6426	1279	NEPONSET RES.	13,721
6428	1370		16,378
6430	1456		19,196
6432	1539		22,191
6434	1624		25,354
6436	1700		28,678
6438	1732		32,110
6440	1803		35,645
6442	1866		39,314
6444	1929		43,109

RESERVOIRS

— UTAH —

NEPONSET RESERVOIR

Dogseret livestock Co.

<u>Contour</u>	<u>Area</u>	<u>Volume</u>	<u>Total volume</u>
6,400.8	0		0
		6	
6,402.4	7		6
		104	
6,405.8	54		110
		1,317	
6,411.8	385		1,427
		2,940	
6,416.8	771		4,367
		972	
6,418.0	824		5,339
		678	
Spillway (1938) 6,418.8	867 *		6,207
		1,070	
6,420.0	925		7,093
6,422.0	1042		9,060

Top of sandbags across spillway; Avg Elev. 6,419.8; Cap. 6,900 cu.ft.
 Crest of spillway, bottom of sandbags; Elev. 6,418.4; Cap. 5,850 cu.ft.

Capacity table from U.S. Bureau Reclamation Survey, 1939.
 Sandbag & spillway elevations from L.S.S. survey, Nov 6, 1951

RED. 1951 - 1951

Saleratus Cr
Sec 2 T6N R6E

Deseret Livestock Co.

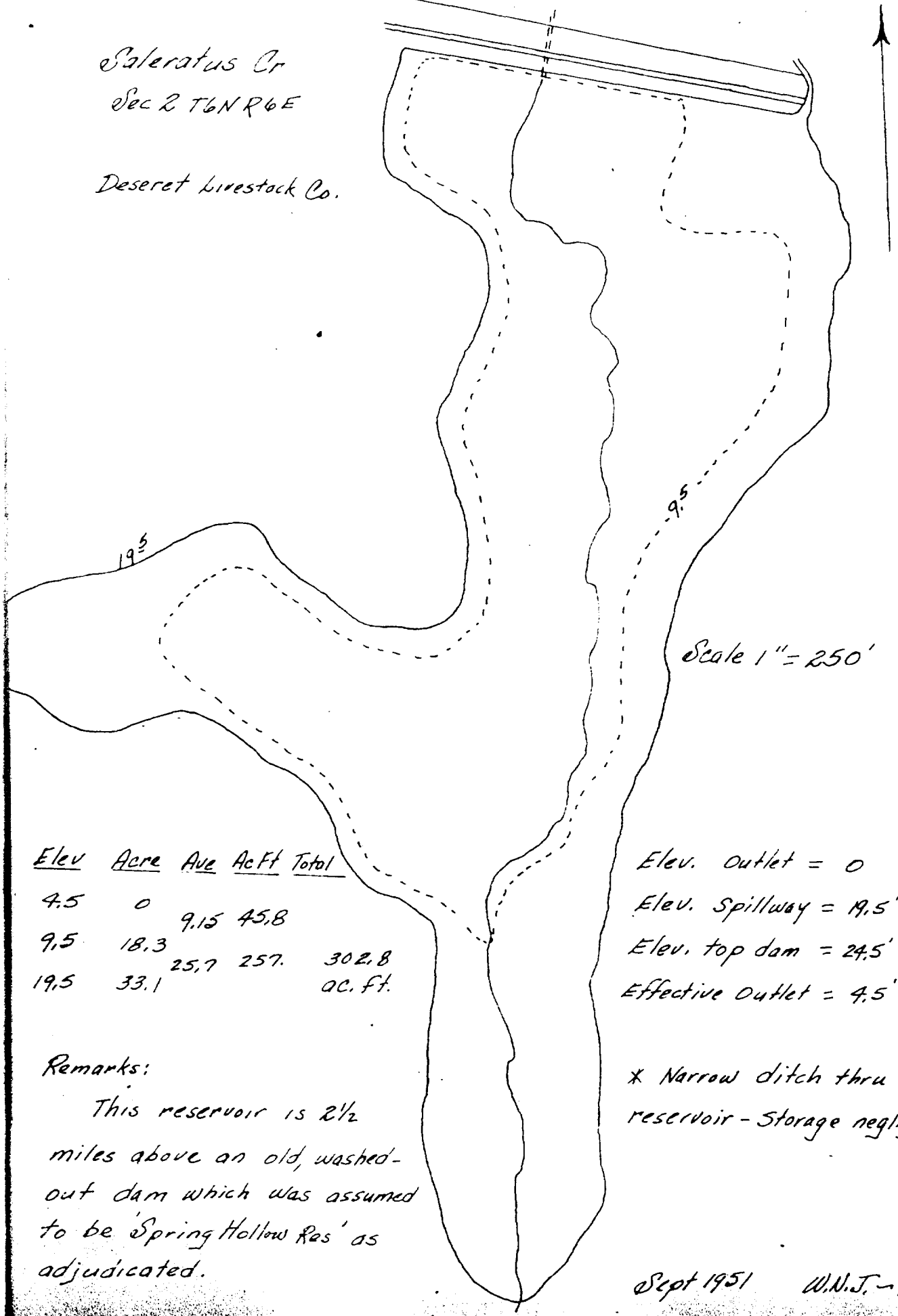

Scale 1" = 250'

Elev	Acre	Ave	Ac Ft	Total
4.5	0	9.15	45.8	
9.5	18.3	25.7	257.	302.8
19.5	33.1			ac. ft.

Elev. Outlet = 0
 Elev. Spillway = 19.5'
 Elev. top dam = 24.5'
 Effective Outlet = 4.5' *

Remarks:

This reservoir is 2 1/2 miles above an old, washed-out dam which was assumed to be 'Spring Hollow Res' as adjudicated.

* Narrow ditch thru reservoir - Storage negligible

Sept 1951 W.N.J. - B.S.R.

RESERVOIRS - LITON

Saleratus Creek

owner: Desert Livestock Co.

Beaver Res.

Sec 2 T6N R6E

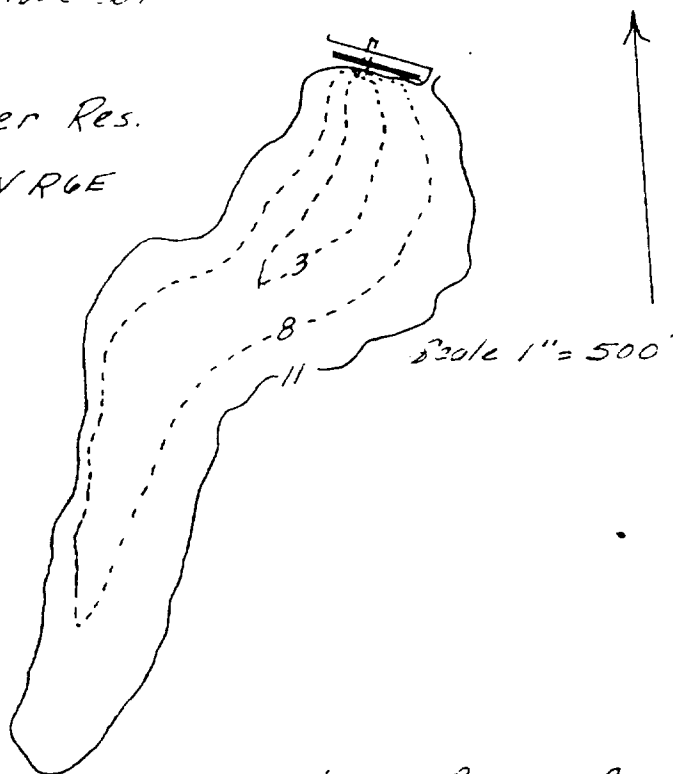

	<u>Elev</u>	<u>Acres</u>	<u>Ave.</u>	<u>Ac.Ft.</u>	<u>Total</u>
Elev. Outlet = 0'					
Elev. Spillway = 11'	0	0	6.5	2.0	
Elev. Top dam = 15'	3	1.3	4.95	24.8	
	8	8.6	12.9	38.7	65.5 ac.
	11	17.2			

Remarks:

Location appears to be coincident with original filing on Beaver reservoir. All reservoirs on Saleratus and tributaries are new or have been modified recently - Spillway on this reservoir is in process of completion.

Sept 1951

W.M.J. - B.S.R.

RESERVOIRS → UTAH

owner: Desert land & livestock

East Fork Saleratus Creek

Sec. 12 T4N R6E

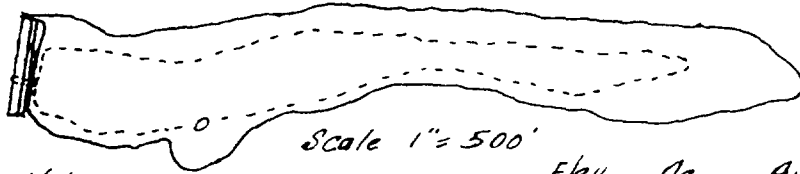

Elev. Outlet = 0	<u>Elev.</u>	<u>Ac.</u>	<u>Ave.</u>	<u>Ac. Ft.</u>	<u>Total</u>
Elev. W.S. = 0	0	5.2			
Elev. Spillway = 7.5'			8.4	63	63 ac. ft.
Elev. Top dam = 10'	7.5	11.6			

Saleratus Cr.

Sec 11 T6N R6E

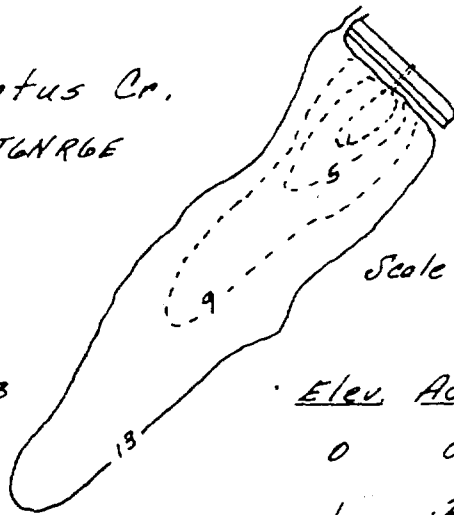

Elev. Outlet = 0
 Elev. W.S. = 13
 Elev. Spill = 12.3

<u>Elev.</u>	<u>Ac.</u>	<u>Ave.</u>	<u>Ac. Ft.</u>	<u>Total</u>
0	0	.10	.10	
1	.2	.55	2.2	
5	.9	2.15	8.6	
9	3.4	6.65	26.5	37.4 ac. ft.
13	9.9			

Remarks:

Location only approximate - Both reservoirs are new or modified recently.

Sept 1951

W.N.J. → B.S.R.

← North

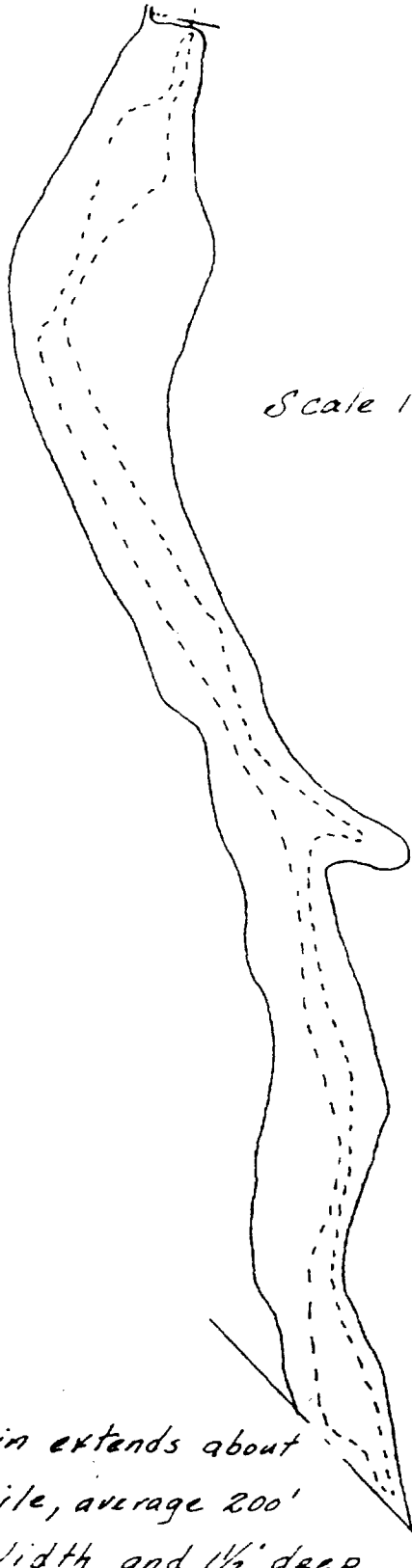

Crane Reservoir
Duck Cr - Wahsatch Cr - Bear R.

Sec 10 & 11 T6N R7E

Scale 1" = 1,000'

- Elev. Outlet = 0'
- Elev. W.S. = 0'
- Elev. Spillway = 10'
- Elev. Top dam = 13'

Elev.	Acres	Ave. Ac.Ft.	Total
0	30.9		
		71.4	71.4
10	112.0		

Extension not mapped: $\frac{2640 \times 200 \times 1.5}{43560} = 18.0$ acft

Total Capacity = 732 ac.ft.

Basin extends about .5 mile, average 200' in width and 1 1/2' deep during high water

Sept. 1951

W.H.T. - B.S.R.

FRESHER CREEK - EQUINO

CHEER CREEK - Sec 36 T135 R45E

Owner: W.G. Lloyd et al.

<u>Elev.</u>	<u>Acres</u>	<u>Average</u>	<u>Ac. Ft.</u>	<u>Total</u>
89	1.25		1.25	1.25
		4.50	18.00	19.25
93	7.75			
		13.87	55.48	74.73
97	20.00			
		23.25	46.50	121.23
99	26.50			
		31.25	93.16	<u>214.83</u>
* 102	36			

* Spillway, original elev. 99', was raised an indeterminate amount believed to be approx. 3'. Capacity curve extended to elev. 102 & additional approx. Contents computed. Filing based on original spillway.

Except as noted above, Contents taken from Engineer's survey (Delbert Smith - Preston, Idaho)

Sept 1951

W.N.J.

T135 R46 E0495
Wood Canyon - Thomas Fork
Three Reservoirs

Owner: A.A. Covey
Salt Lake City

Elev. Outlet = 0'
Elev. W.S. = 2.5'
Elev. Spillway = 8.0'
Ave depth Water = 2.0'

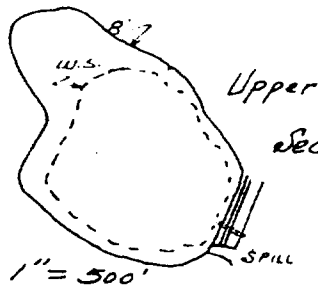

Elev.	Ac.	Ave.	Ac.Ft.	Total
0	3.8	3.8	7.6	
2.0	3.8			
8.0	4.0	4.9	29.4	37.0 ac.ft.

Elev. Outlet = 0'
Elev. W.S. = 2
Elev. Spill(2) = 16.5

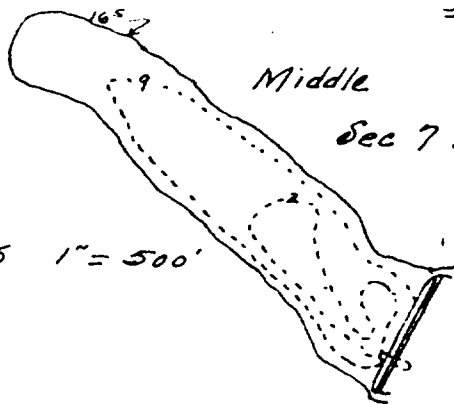

Elev.	Ac.	Ave.	Ac.Ft.	Total
0	0	.55	1.1	
2.0	1.1			
9.0	4.4	2.85	19.8	
16.5	7.5	6.05	45.4	66.3 ac.ft.

Elev. Outlet = 0
Elev. Spillway = 8'

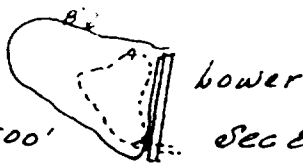

Elev.	Acres	Ave.	Ac.Ft.	Total
0	0			
4	.45	.22	0.9	
8	2.0	1.22	4.9	5.8 ac.ft.

Remarks:

Oct 1951

W.N.J. - B.S.R.